

STREET LIGHT 2018.V1

International On-line Sales Dept.-Outdoor Light

PH: 0574-62805278

0574-62805275

FX: 0574-62805277

MB: 13958391970

(24 Hours service calling)

Email: sales@sctlite.com

peter_lamps@163.com

[Http://www.sctlite.com](http://www.sctlite.com) , sctlite.en.alibaba.com

[Http://www.peterlamps.com](http://www.peterlamps.com) , peterlamps.en.alibaba.com

Professional supplier in outdoor lighting , both in street & garden lights

SCHTLITE LIGHT CO., LIMITED

Changxin Road 39#, Yuyao City 315400, Zhejiang , China

COMPREHENSIVE VERSION BY SCHTLITE PICTURE 2018

1.1. LED STREET-TOP POST LIGHT : (P.001 - P.034)



ARULA.LED
(P.01-05)



DQR.LED
(P.06-08)



GAMALA
(P.09-010)



ISLA.LED
(P.011-013)



HISPALIS
(P.014-017)



PISA480.LED
(P.018-020)



RAINFOREST
(P.021-022)



RUBY.LED
(P.023-025)



RAVAL



TOPEKA
(P.026-027)



UFO
(P.031-033)



VALLENCAY.LED
(P.028-030)



LED 路灯 STREET LIGHT

Lighting Distribution:(optional)

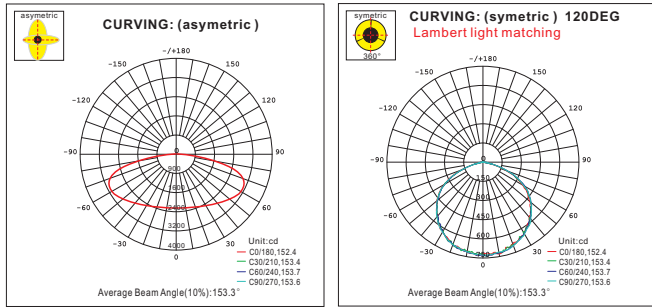

ALURA 艾露拉

ALURA.LED

Street of top post designed for vertical installation. Die casting Aluminum body and anti-Shock & UV PC diffuser, which is in high-strength without broken.

LED is made of PHILIPS Lumileds 3030 or 5050 (high efficiency). Available in various finishes : white , grey, black , etc.,

PC DIFFUSER (OPTIONAL)



CL-Clear PC

FRS-Frost PC

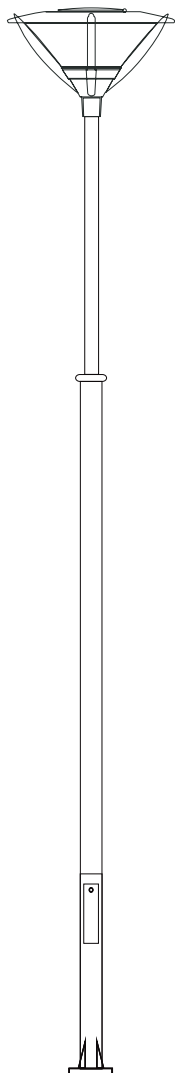

WOLF-H

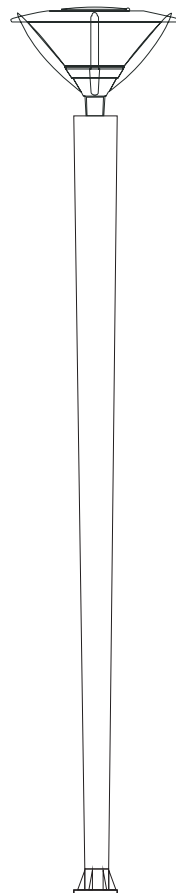

MACUBA-SM

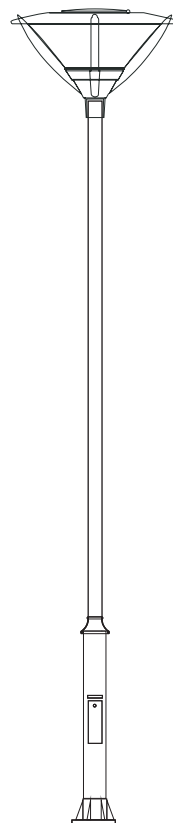

BUSSY

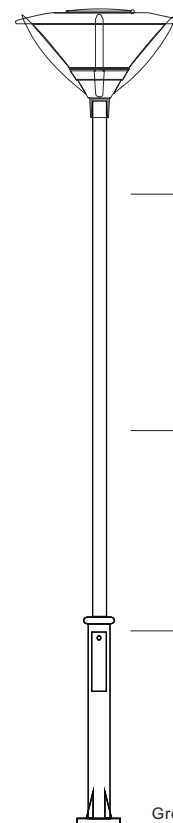

WOLF

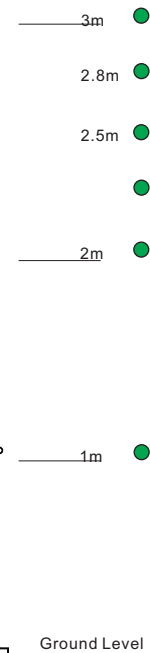

For installation of Street Light -Vertical Mounted Type

Model : PL30690ALA.480/LQ1

IP66



PL30690ALA.480W80/LQ2
 PL30690ALA.480W100/LQ2
 PL30690ALA.480W120/LQ2



Outlook Viewing



IP68

Viewing of LED Module

The photograph may not match the reference exactly. Please to read the product description to identify the finish .



CURVING: (asymetric)

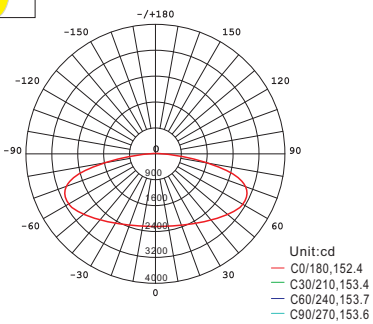

CURVING: (symetric) 120DEG
 Lambert light matching

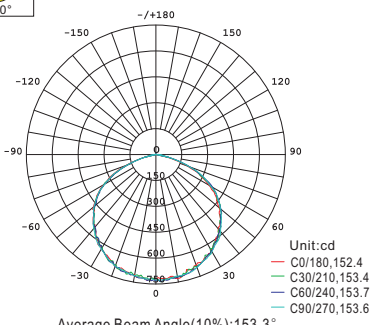

DESCRIPTION:

Street of top post designed for vertical installation. Aluminum body and anti-Shock & UV PC diffuser from LED Module ,which is in high-strength without broken .

LED is made of PHILIPS LUMILEDS 3030.
 Available in various finishes : white , grey, black , etc.,

TECHNICAL CHARACTERISTICS:

| | |
|------------------------|--|
| Type: | LED Street- Top Post Mounted |
| IP Protection degrees: | IP68 (LED PART) |
| Safety Class : | Class-I |
| Working Temperature : | -25 ~ +50℃ |
| Voltage/Frequency : | 220-240V ,50/60HZ 100-275V ,50/60HZ |



LED SPECIFICATIONS: (Q1, ≥105lm±5%/LED3030,CRI≥70)

Item No.: **PL30690ISL.480W80/LQ2**

LEDs: Phillips Lumileds 3030 3*45LEDs,80W

LEDs : 3000/4000K/5700K ,CRI≥70

Item No.: **PL30690ISL.480W120/LQ2**

LEDs: Phillips Lumileds 3030 2*63LEDs,120W

LEDs : 3000/4000K/5700K ,CRI≥70

Item No.: **PL30650ISL.674W100/LQ2**

LEDs: Phillips Lumileds 3030 2*63LEDs,100W

LEDs : 3000/4000K/5700K ,CRI≥70

Box Size/Unit : 79*69*24cm

Gross Weight (kg) : 11.2Kg/1PC

Note:
 63LED3030 optional , details turn to
 "LED module-M8A"

Checking the price else for :
LED5050 ≥130lm±5/W
 (high efficiency)



Structure material: Die-casting aluminium
Structure finish: Grey, White, Black, Silver

Diffuser Material:
 Anti-UV PC/Polycarbonate

SAMPLE FOR STICK LABELS:

Product Description **YOUR LOGO®**

50W LED STREET LIGHT

| | |
|---|---------------------------|
| Color Temp 3000K | Protection IP66 |
| Power Supply 100-240V AC, 50-60Hz | Power Rate 50W |

Product Part #: xxxxxxxx

+86 574 62805278
 +86 574 62805277
 sales@schtlite.com
 www.schtlite.com

#49, Changxin Road, Yuyao City, Ningbo Of Zhejiang ,China

Stick Label of box & carton

50W LED STREET LIGHT **YOUR LOGO®**

Product Part #: xxxxxxxx

| | | |
|------------|----------------------------|------------------|
| Power: 50W | Input:100-240V AC, 50-60Hz | Protection: IP66 |
|------------|----------------------------|------------------|

Stick Label of Lamp Body

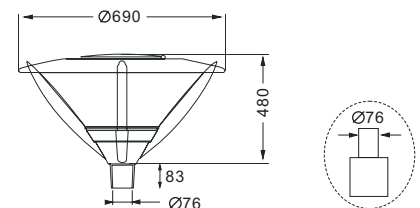

SCHTLITE LIGHT CO., LIMITED

Office and Factory
 #777, Huan cheng Rd, Yuyao City ,Ningbo Of Zhejiang ,China
 Tel: +86-574-62805278 Fax: +86-574-62805277
 Email : sales@schtlite.com

service at alibaba.com
 we have our website at alibaba.com
 for all of our outdoor series of lighting
 with the page :
peterlamps.en.alibaba.com



For installation of Street Light -Vertical Mounted Type

Model : PL50690ALA.480/LQ

IP66



PL50690ALA.480W80/LQ2
 PL50690ALA.480W100/LQ2
 PL50690ALA.480W120/LQ2



Outlook Viewing



IP68

Viewing of LED Module

The photograph may not match the reference exactly. Please to read the product description to identify the finish .

DESCRIPTION:

Street of top post designed for vertical installation. Aluminum body and anti-Shock & UV PC diffuser from LED Module ,which is in high-strength without broken .

LED is made of PHILIPS LUMILEDS 5050.
 Available in various finishes : white , grey, black , etc.,

TECHNICAL CHARACTERISTICS:

| | |
|------------------------|--|
| Type: | LED Street- Top Post Mounted |
| IP Protection degrees: | IP68 (LED PART) |
| Safety Class : | Class-I |
| Working Temperature : | -25 ~ +50℃ |
| Voltage/Frequency : | 220-240V ,50/60HZ 100-275V ,50/60HZ |



LED SPECIFICATIONS: (LQ2, ≥130lm±5/W /18LED5050)

Item No.: PL50690ALA.480W80/LQ2

LEDs: Phillips Lumileds 5050 2*18LEDs,80W

LEDs :3000/4000K ,CRI≥70, ≥105lm±5/W

Item No.: PL50690ALA.480W120/LQ2

LEDs: Phillips Lumileds 5050 2*18LEDs,120W

LEDs :3000/4000K ,CRI≥70, 105lm±5/W

Item No.: PL50690ALA.480W100/LQ2

LEDs: Phillips Lumileds 5050 2*18LEDs,100W

LEDs :3000/4000K ,CRI≥70, ≥105lm±5/W

Box Size/Unit : 57*57*57cm

Gross Weight (kg) : 11.2Kg/1PC

Note:

24LED5050 optional , details turn to "LED module-M16A"

Checking the price else for :
LED3030 ≥105lm±5/W
 (high efficiency)



CURVING: (asymetric)

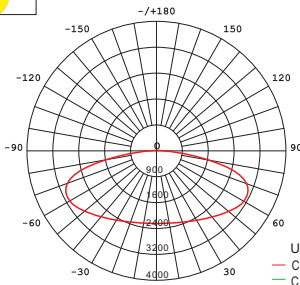

Unit:cd
 - C0/180,152.4
 - C30/210,153.4
 - C60/240,153.7
 - C90/270,153.6

Average Beam Angle(10%):153.3°



CURVING: (symetric) 120DEG Lambert light matching

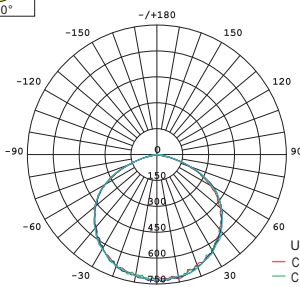

Unit:cd
 - C0/180,152.4
 - C30/210,153.4
 - C60/240,153.7
 - C90/270,153.6

Average Beam Angle(10%):153.3°



Structure material: Die-casting aluminium
 Structure finish: Grey, White, Black, Silver

Diffuser Material:
 Anti-UV PC/Polycarbonate

SAMPLE FOR STICK LABELS:

Product Description **YOUR LOGO®**

50W LED STREET LIGHT

| | |
|---|---------------------------|
| Color Temp 3000K | Protection IP66 |
| Power Supply 100-240V AC, 50-60Hz | Power Rate 50W |

Product Part #: xxxxxxxx

+86 574 62805278
 +86 574 62805277
 sales@schtlite.com
 www.schtlite.com

#49, Changxin Road, Yuyao City, Ningbo Of Zhejiang ,China

Stick Label of box & carton

50W LED STREET LIGHT **YOUR LOGO®**

Product Part #: xxxxxxxx

| | | |
|------------|----------------------------|------------------|
| Power: 50W | Input:100-240V AC, 50-60Hz | Protection: IP66 |
|------------|----------------------------|------------------|

Stick Label of Lamp Body

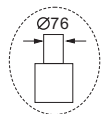
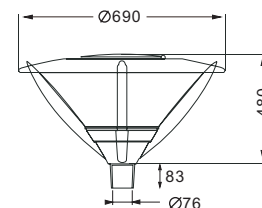

SCHTLITE LIGHT CO., LIMITED

Office and Factory
 #777, Huan cheng Rd, Yuyao City ,Ningbo Of Zhejiang ,China
 Tel: +86-574-62805278 Fax: +86-574-62805277
 Email : sales@schtlite.com

service at alibaba.com
 we have our website at alibaba.com
 for all of our outdoor series of lighting
 with the page :
peterlamps.en.alibaba.com



For installation of LED Module/Q Street Light -Vertical Mounted Type
 Model : PL30690ALA.480/Q1 , PL50690ALA.480/Q1

IP66



The photograph may not match the reference exactly. Please to read the product description to identify the finish .

LED3030 ≥ 105lm±5/W

- PL30690ALA.480W30/Q1
- PL30690ALA.480W40/Q1
- PL30690ALA.480W50/Q1
- PL30690ALA.480W60/Q1

LED5050 ≥ 130lm±5/W (high efficiency)

- PL50690ALA.480W30/Q1
- PL50690ALA.480W40/Q1
- PL50690ALA.480W50/Q1
- PL50690ALA.480W60/Q1

Lighting Distribution:(optional)

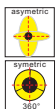

CURVING: (asymmetric)

CURVING: (symetric) 120DEG Lambert light matching

Box Size/Unit : 57*57*57cm

Gross Weight (kg) : 11.2Kg/1PC



IP68 Cable Connector



Maintenance



Outlook Viewing



Viewing of LED Module

DESCRIPTION:

Street of top post designed for vertical installation. Die casting Aluminum body and anti-Shock & UV PC diffuser ,which is in high-strength without broken .

LED is made of PHILIPS Lumileds 3030 or 5050 (high efficiency). Available in various finishes : white , grey, black , etc.,

TECHNICAL CHARACTERISTICS:

| | |
|------------------------|--|
| Type: | LED Street- Top Post Mounted |
| IP Protection degrees: | IP68 (LED PART) |
| Safety Class : | Class-I |
| Working Temperature : | -25 ~ +50°C |
| Voltage/Frequency : | 220-240V ,50/60HZ 100-275V ,50/60HZ |



LED SPECIFICATIONS: (Q1,105lm±5/W /LED3030)

| | |
|---|---|
| Item No.: PL30690ALA.480W30/Q1 | Item No.: PL30690ALA.480W40/Q1 |
| LEDs: Phillips Lumileds 3030 35LEDs,30W | LEDs: Phillips Lumileds 3030 45LEDs,40W |
| Item No.: PL30690ALA.480W50/Q1 | Item No.: PL30690ALA.480W60/Q1 |
| LEDs: Phillips Lumileds 3030 49LEDs,50W | LEDs: Phillips Lumileds 3030 63LEDs,60W |

LED SPECIFICATIONS: (Q1,135lm±5/W /LED5050,high efficiency)

| | |
|---|---|
| Item No.: PL50690ALA.480W30/Q1 | Item No.: PL50690ALA.480W40/Q1 |
| LEDs: Phillips Lumileds 5050 14LEDs,30W | LEDs: Phillips Lumileds 5050 14LEDs,40W |
| Item No.: PL50690ALA.480W50/Q1 | Item No.: PL50690ALA.480W60/Q1 |
| LEDs: Phillips Lumileds 5050 18LEDs,50W | LEDs: Phillips Lumileds 5050 18LEDs,60W |



MATERIALS/FINISHES:

Structure material: Die-casting aluminium
Structure finish: Grey, White, Black, Silver

Diffuser Material: Anti-UV PC/Polycarbonate

SAMPLE FOR STICK LABELS:

Product Description **YOUR LOGO®**

50W LED STREET LIGHT

| | |
|---|---------------------------|
| Color Temp 3000K | Protection IP66 |
| Power Supply 100-240V AC, 50-60Hz | Power Rate 50W |
| Product Part #: xxxxxxxx | |

☎ +86 574 62805278
 ☎ +86 574 62805277
 ✉ sales@schtlite.com
 www.schtlite.com

#49, Changxin Road, Yuyao City, Ningbo Of Zhejiang ,China

Stick Label of box & carton

50W LED STREET LIGHT **YOUR LOGO®**

Product Part #: xxxxxxxx

| | | |
|------------|----------------------------|------------------|
| Power: 50W | Input:100-240V AC, 50-60Hz | Protection: IP66 |
|------------|----------------------------|------------------|

Stick Label of Lamp Body

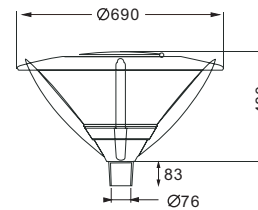

Dimensions (mm)

SCHTLITE LIGHT CO., LIMITED

Office and Factory
 #777, Huan cheng Rd, Yuyao City ,Ningbo Of Zhejiang ,China
 Tel: +86-574-62805278 Fax: +86-574-62805277
 Email : sales@schtlite.com

service at alibaba.com
 we have our website at alibaba.com for all of our outdoor series of lighting with the page :
peterlamps.en.alibaba.com



For installation of Street Light -Vertical Mounted Type
Model : PL30690ALA.480/R

IP66



PL30690ALA.480W60/R3
PL30690ALA.480W80/R4
PL30690ALA.480W100/R5

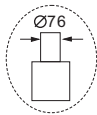
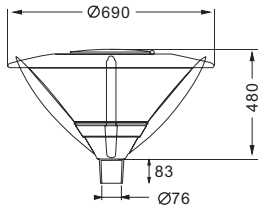

The photograph may not match the reference exactly. Please to read the product description to identify the finish .

DESCRIPTION:

Street of top post designed for vertical installation. Aluminum body and anti-Shock & UV PC diffuser from LED Module ,which is in high-strength without broken .

LED is made of PHILIPS LUMILEDS 3030.
Available in various finishes : white , grey, black , etc.,

TECHNICAL CHARACTERISTICS:

| | |
|------------------------|------------------------------|
| Type: | LED Street- Top Post Mounted |
| IP Protection degrees: | IP68 (LED PART) |
| Safety Class : | Class-I |
| Working Temperature : | -25 ~ +50℃ |
| Voltage/Frequency : | 220-240V/100-275V ,50/60HZ |
| Box Size/Unit : | 57*57*57cm |
| Gross Weight (kg) : | 11.2Kg/1PC |



LED SPECIFICATIONS: (R, ≥105lm±5/W /LED3030)

| | |
|--|---|
| Item No.: PL30690ALA.480W60/R3 | Item No.: PL30690ALA.480W80/R4 |
| LEDs: Phillips Lumileds 3030 3*24LEDs,60W | LEDs: Phillips Lumileds 3030 4*24LEDs,80W |
| LEDs : 3000/4000/5700K,CRI≥70,≥105lm±5/W | LEDs: 3000/4000/5700K,CRI≥70,≥105lm±5/W |
| Item No.: PL30690ALA.480W100/R5 | |
| LEDs: Phillips Lumileds 3030 5*24LEDs,100W | |
| LEDs : 3000/4000/5700K,CRI≥70,≥105lm±5/W | |

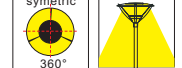
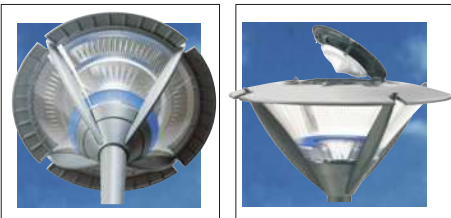

MATERIALS/FINISHES:

Structure material: Die-casting aluminium
Structure finish: Grey, White, Black, Silver

Diffuser Material:
Anti-UV PC/Polycarbonate

SAMPLE FOR STICK LABELS:

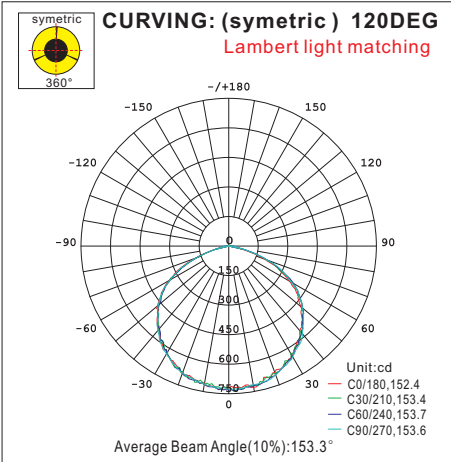

Product Description **YOUR LOGO®**

60W LED STREET LIGHT

| | |
|---|---------------------------|
| Color Temp 3000K | Protection IP66 |
| Power Supply 100-240V AC, 50-60Hz | Power Rate 60W |

Product Part #: xxxxxxxx

+86 574 62805278
+86 574 62805277
sales@schtlite.com
www.schtlite.com

#49, Changxin Road, Yuyao City, Ningbo Of Zhejiang ,China

60W LED STREET LIGHT YOURLOGO®

Product Part #: xxxxxxxx

| | | |
|------------|----------------------------|------------------|
| Power: 60W | Input:100-240V AC, 50-60Hz | Protection: IP66 |
|------------|----------------------------|------------------|

Stick Label of Lamp Body

Not dimmable LED in warm white

A+ **A** **B** **C** **D** **E**

ENERGY CLASS
енергия - енергетика

| | |
|-----------|---------------------------|
| ≥70 | CRI |
| 2.7 | kwh/1000h |
| 90 degree | Beam Angle |
| 60W | Max LED Watt |
| 5700K | Color Temperature |
| 0%~95% | Environmental Humidity |
| ≥105lm | Minimum luminous flux |
| -35℃~65℃ | Environmental Temperature |

Energy Consumption Lable

Stick Label of box & carton

SCHTLITE LIGHT CO., LIMITED

Office and Factory
#777, Huan cheng Rd, Yuyao City ,Ningbo Of Zhejiang ,China
Tel: +86-574-62805278 Fax: +86-574-62805277
Email : sales@schtlite.com

service at alibaba.com
we have our website at alibaba.com for all of our outdoor series of lighting with the page :
peterlamps.en.alibaba.com



LED 路灯 STREET LIGHT

Lighting Distribution:(optional)

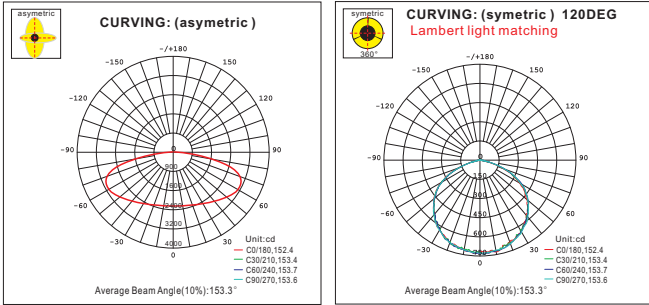

DQR 光明

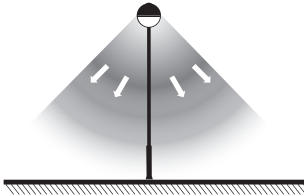

DQR

She is comprised of a spun aluminum body topped by a cast aluminum alloy support and a transparent polycarbonate protector.

It is equipped with a long-term Ip65 optical compartment, characterised by a reflector sealed to the protector and by unique access via the lamp holder supporting plug fitted with a short gasket.

MELON

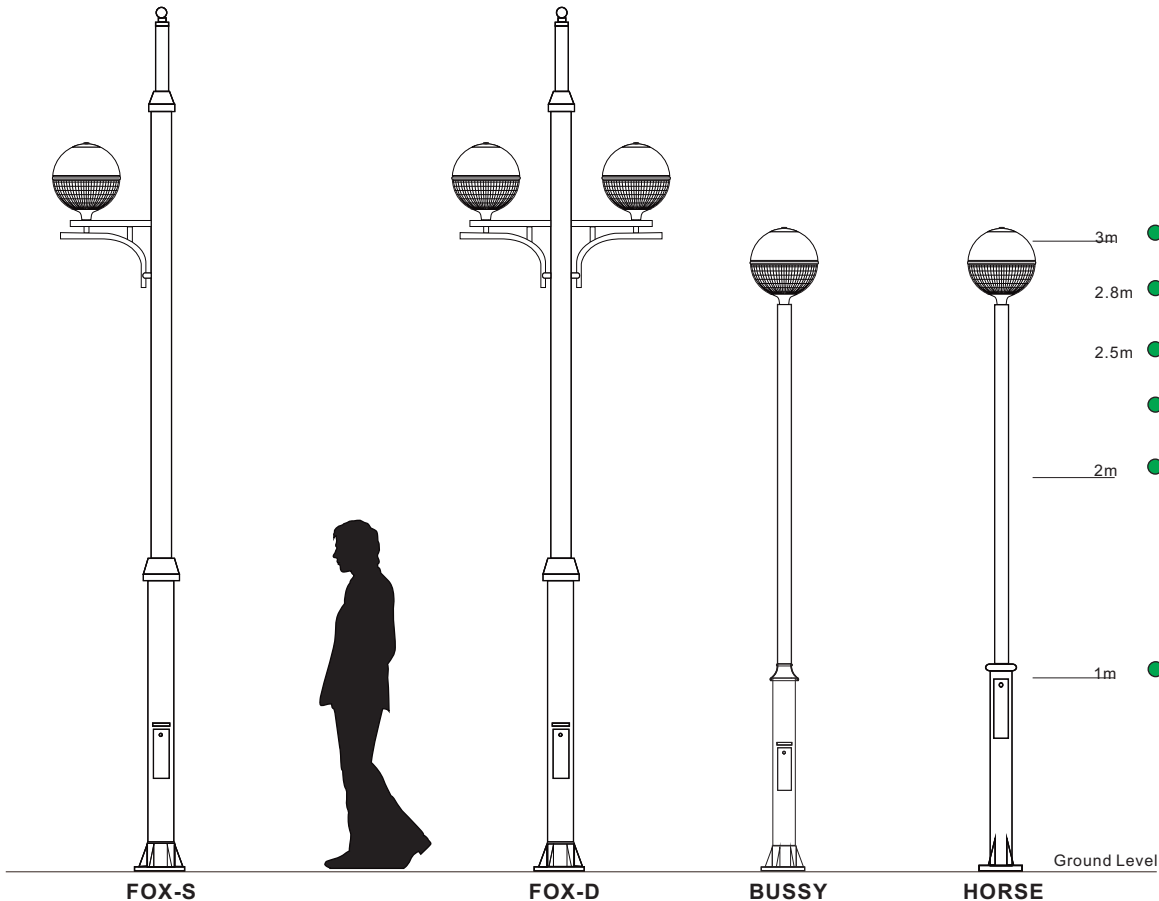

For installation of Street Light -Vertical Mounted Type

Model : PL30400DQR.490/Q1

IP66



The photograph may not match the reference exactly. Please to read the product description to identify the finish .

LED3030 ≥ 105lm±5/W

- PL30400DQR.490W30/Q1
- PL30400DQR.490W40/Q1
- PL30400DQR.490W50/Q1
- PL30400DQR.490W60/Q1

LED5050 ≥ 130lm±5/W (high efficiency)

- PL50400DQR.490W30/Q1
- PL50400DQR.490W40/Q1
- PL50400DQR.490W50/Q1
- PL50400DQR.490W60/Q1

Lighting Distribution:(optional)

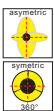

CURVING: (asymetric)

CURVING: (symetric) 120DEG Lambert light matching

IP68 LED Module 3*20W standard

IP66

Box Size/Unit : 50*50*51cm

Gross Weight (kg) : 7.25Kg/1PC



Viewing of connector



Viewing of LED Module

DESCRIPTION:

Street of top post designed for vertical installation. Aluminum body and anti-Shock & UV PC diffuser from LED Module ,which is in high-strength without broken .

LED is made of PHILIPS Lumileds 3030 & 5050. Available in various finishes : white , grey, black , etc.,

TECHNICAL CHARACTERISTICS:

| | |
|------------------------|--|
| Type: | LED Street- Top Post Mounted |
| IP Protection degrees: | IP68 (LED PART) |
| Safety Class : | Class-I |
| Working Temperature : | -25 ~ +50°C |
| Voltage/Frequency : | 220-240V ,50/60HZ 100-275V ,50/60HZ |



LED SPECIFICATIONS: (Q1,105lm±5/W /LED3030)

| | |
|---|---|
| Item No.: PL30400DQR.490W30/Q1 | Item No.: PL30400DQR.490W40/Q1 |
| LEDs: Phillips Lumileds 3030 35LEDs,30W | LEDs: Phillips Lumileds 3030 45LEDs,40W |
| Item No.: PL30400DQR.490W50/Q1 | Item No.: PL30400DQR.490W60/Q1 |
| LEDs: Phillips Lumileds 3030 49LEDs,50W | LEDs: Phillips Lumileds 3030 63LEDs,60W |

LED SPECIFICATIONS: (Q1,135lm±5/W /LED5050,high efficiency)

| | |
|---|---|
| Item No.: PL50400DQR.490W30/Q1 | Item No.: PL50400DQR.490W40/Q1 |
| LEDs: Phillips Lumileds 5050 14LEDs,30W | LEDs: Phillips Lumileds 5050 14LEDs,40W |
| Item No.: PL50400DQR.490W50/Q1 | Item No.: PL50400DQR.490W60/Q1 |
| LEDs: Phillips Lumileds 5050 18LEDs,50W | LEDs: Phillips Lumileds 5050 18LEDs,60W |



MATERIALS/FINISHES:

Structure material: Die-casting aluminium
Structure finish: Grey, White, Black, Silver

Diffuser Material: Anti-UV PC/Polycarbonate

SAMPLE FOR STICK LABELS:

Product Description **YOUR LOGO®**

60W LED STREET LIGHT

| | |
|---|---------------------------|
| Color Temp 3000K | Protection IP66 |
| Power Supply 100-240V AC, 50-60Hz | Power Rate 60W |

Product Part #: xxxxxxxx

+86 574 62805278
+86 574 62805277
sales@schtlite.com
www.schtlite.com

CLASS I
IEC A
IP65
IK 08
CE

#49, Changxin Road, Yuyao City, Ningbo Of Zhejiang ,China

Stick Label of box & carton

60W LED STREET LIGHT **YOUR LOGO®**

Product Part #: xxxxxxxx

| | | |
|------------|----------------------------|------------------|
| Power: 60W | Input:100-240V AC, 50-60Hz | Protection: IP66 |
|------------|----------------------------|------------------|

Stick Label of Lamp Body

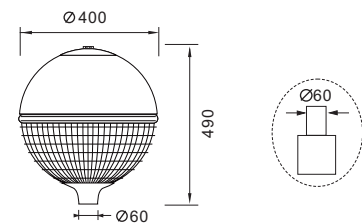

Size Illustrations

SCHTLITE LIGHT CO., LIMITED

Office and Factory
#49, Changxin Road, Yuyao City ,Ningbo Of Zhejiang ,China
Tel: +86-574-62805278 Fax: +86-574-62805277
Email : sales@schtlite.com

service at alibaba.com
we have our website at alibaba.com for all of our outdoor series of lighting with the page :
peterlamps.en.alibaba.com



For installation of LED Street Light -Vertical Mounted Type

Model : PL30400DQR.490/R3, PL30400DQR.490/R4

IP66



PL30400DQR.490W30/R3
 PL30400DQR.490W40/R4
 PL30400DQR.490W50/R3
 PL30400DQR.490W60/R3



DESCRIPTION:

Street of top post designed for vertical installation. Aluminum body and anti-Shock & UV PC diffuser from LED Module, which is in high-strength without broken.

LED is made of PHILIPS LUMILEDS 3030.
 Available in various finishes : white , grey, black , etc.,

TECHNICAL CHARACTERISTICS:

Type: LED Street- Top Post Mounted
 IP Protection degrees: IP68 (LED PART)
 Safety Class : Class-I
 Working Temperature : -40 ~ +50°C
 Voltage/Frequency : 120-240V ,50/60HZ
 100-277V ,50/60HZ
 200-277V ,50/60HZ



LED SPECIFICATIONS: ($\geq 105lm\pm 5/W$ /LED3030,CRI ≥ 70)

| | |
|--|---|
| Item No.: PL30400DQR.490W30/R3 | Item No.: PL30400DQR.490W40/R4 |
| LEDs: Phillips Lumileds 3030 3*10LEDs,30W | LEDs: Phillips Lumileds 3030 4*10LEDs,40W |
| LEDs : 3000K/4000K/500K/5700K, $\geq 105lm\pm 5/W$ | LEDs : 3000K/4000K/5000K/5700K, $\geq 105lm\pm 5/W$ |
| Item No.: PL30400DQR.490W50/R3 | Item No.: PL30400DQR.490W60/R3 |
| LEDs: Phillips Lumileds 3030 3*25LEDs,50W | LEDs: Phillips Lumileds 3030 3*24LEDs,60W |
| LEDs : 3000K/4000K/500K/5700K, $\geq 105lm\pm 5/W$ | LEDs : 3000K/4000K/5000K/5700K, $\geq 105lm\pm 5/W$ |

| | | |
|---------------------------------------|--|-------------|
| Box Size/Unit : 50*50*51cm | IP68 LED Module 3*20W standard | IP66 |
| Gross Weight (kg) : 7.25Kg/1PC | | |



MATERIALS/FINISHES:

Structure material: Die-casting aluminum
Structure finish: Grey, White, Black, Silver

Diffuser Material:
 Anti-UV PC/Polycarbonate

SAMPLE FOR STICK LABELS:

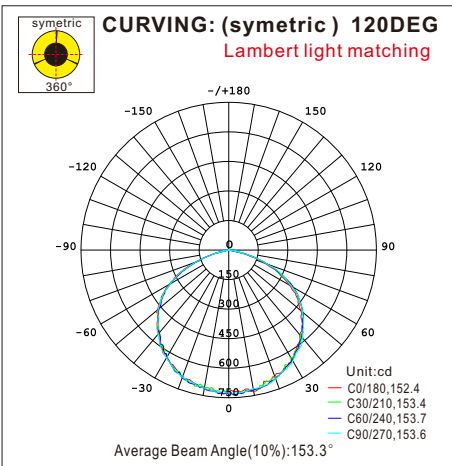

Product Description **YOUR LOGO®**

60W LED STREET LIGHT

| | |
|---|---------------------------|
| Color Temp 3000K | Protection IP66 |
| Power Supply 100-240V AC, 50-60Hz | Power Rate 60W |

Product Part #: xxxxxxxx

+86 574 62805278
 +86 574 62805277
 sales@schtlite.com
 www.schtlite.com

#9, Changxin Road, Yuyao City, Ningbo Of Zhejiang ,China

60W LED STREET LIGHT YOUR LOGO®

Product Part #: xxxxxxxx

| | | |
|------------|----------------------------|------------------|
| Power: 60W | Input:100-240V AC, 50-60Hz | Protection: IP66 |
|------------|----------------------------|------------------|

Stick Label of Lamp Body

Stick Label of box & carton

Size Illustrations

SCHTLITE LIGHT CO., LIMITED

Office and Factory
 #777, Huan cheng Rd, Yuyao City ,Ningbo Of Zhejiang ,China
 Tel:+86-574-62805278 Fax:+86-574-62805277
 Email : sales@schtlite.com

service at alibaba.com
 we have our website at alibaba.com
 for all of our outdoor series of lighting
 with the page :
peterlamps.en.alibaba.com



LED 路灯 STREET LIGHT

Lighting Distribution:(optional)

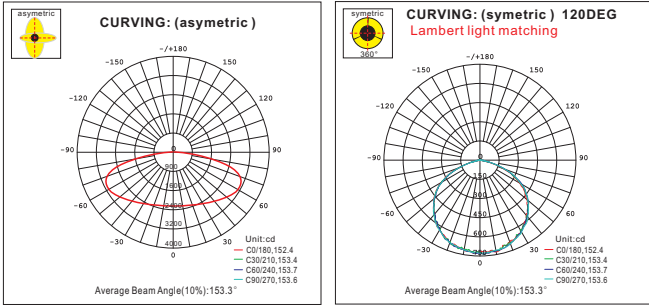

GAMALA

伽玛拉

GAMALA.LED

Street of top post light designed for vertical installation. Die casting aluminum body and Frost glass diffuser .

LED is made of PHILIPS Lumileds 3030 or 5050 (High Efficiency).

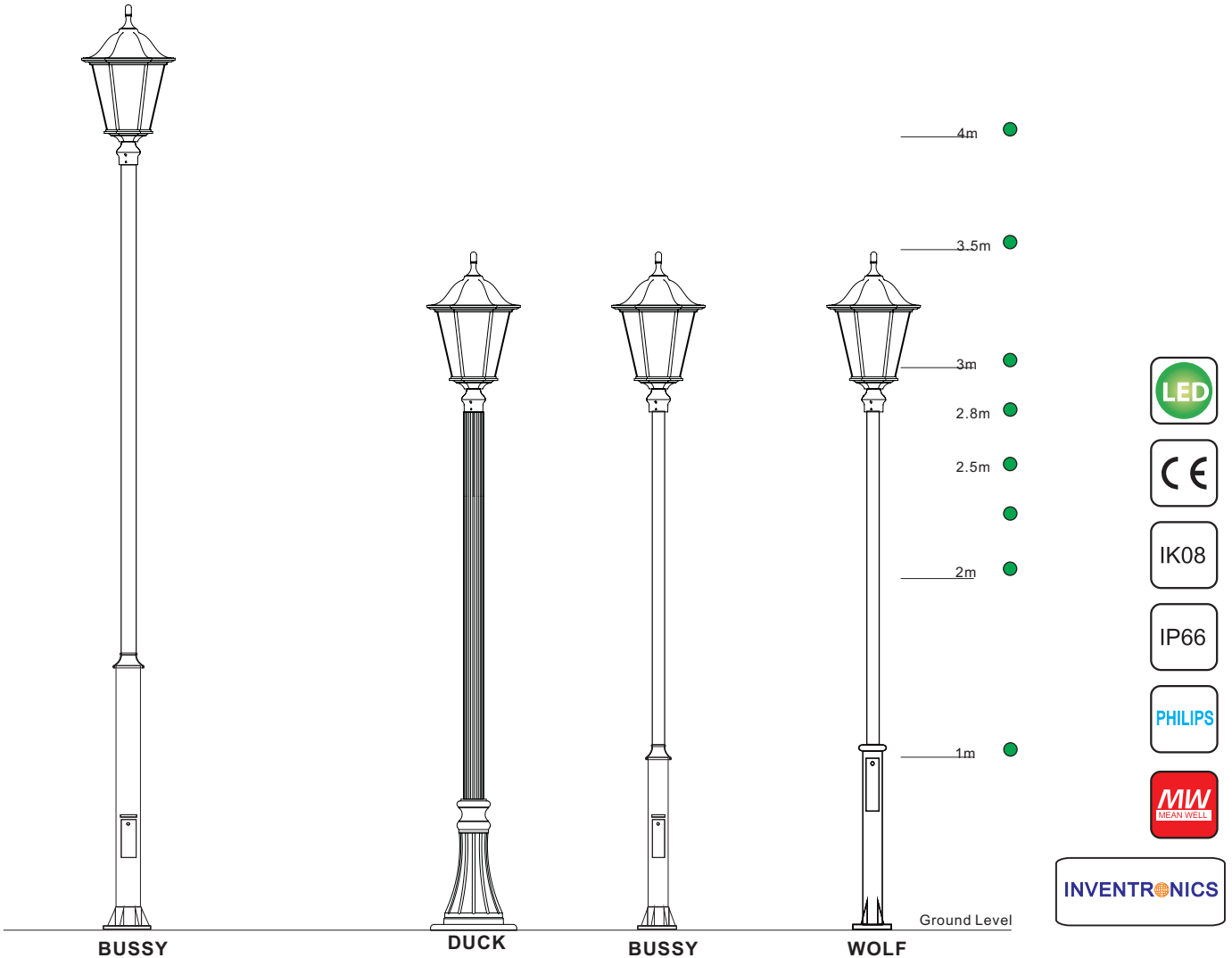

For installation of Street Light -Vertical Mounted Type

Model : PL30440GML.749 , PL50440GML.749

IP66



LED3030 ≥ 105lm±5/W

PL30440GML.749W30/Q1
 PL30440GML.749W40/Q1
 PL30440GML.749W50/Q1
 PL30440GML.749W60/Q1

LED5050 ≥ 130lm±5/W
 (high efficiency)

PL50440GML.749W30/Q1
 PL50440GML.749W40/Q1
 PL50440GML.749W50/Q1
 PL50440GML.749W60/Q1

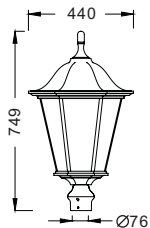

The photograph may not match the reference exactly. Please to read the product description to identify the finish .

3000K/4000K/5000K/5700K ,CRI≥70

Box Size/Unit : ---cm

Gross Weight (kg) : ---Kg/1PC

DESCRIPTION:

Street of top post light designed for vertical installation. Die casting aluminum body and Frost glass diffuser .

LED is made of PHILIPS Lumileds 3030 or 5050 (High Efficiency).

TECHNICAL CHARACTERISTICS:

Type: Street- Vertical Entry

IP Protection degrees: IP68 (LED PART)

IK Protection degrees: IK06

Safety Class : Class-I

Lamp Holder : E40/E27

Voltage/Frequency : 120-240V ,50/60HZ



LED SPECIFICATIONS: (≥105lm±5/W /LED3030, CRI≥70)

Item No.: PL30440GML.749W30/Q1

LEDs: Phillips Lumileds 3030 35LEDs,30W

Item No.: PL30440GML.749W50/Q1

LEDs: Phillips Lumileds 3030 49LEDs,50W

Item No.: PL30440GML.749W40/Q1

LEDs: Phillips Lumileds 3030 45LEDs,40W

Item No.: PL30440GML.749W60/Q1

LEDs: Phillips Lumileds 3030 63LEDs,60W

LED SPECIFICATIONS: (≥130lm±5/W /LED5050, CRI≥70)

Item No.: PL50440GML.749W30/Q1

LEDs: Phillips Lumileds 5050 14LEDs,30W

Item No.: PL50440GML.749W50/Q1

LEDs: Phillips Lumileds 5050 18LEDs,50W

Item No.: PL50440GML.749W40/Q1

LEDs: Phillips Lumileds 5050 14LEDs,40W

Item No.: PL50440GML.749W60/Q1

LEDs: Phillips Lumileds 5050 18LEDs,60W



MATERIALS/FINISHES:

Structure material: Spinning aluminium
 Structure finish: Grey, White, Black, Silver

Diffuser Material:
 IK08 Temper Glass

SAMPLE FOR STICK LABELS:

| | | | |
|--|-------------|---|--|
| Product Description | | YOUR LOGO® | |
| 60W LED STREET LIGHT | | | |
| Color Temp | Protection | | |
| 3000K | IP66 | | |
| Power Supply | Power Rate | | |
| 100-240V AC, 50-60Hz | 60W | | |
| Product Part #: | xxxxxxx | | |
| +86 574 62805278 +86 574 62805277 sales@schtlite.com www.schtlite.com | | CLASS I EEC A IP66 IK 06 CE | |
| #49, Changxin Road, Yuyao City ,Ningbo Of Zhejiang, China | | | |

Stick Label of box & carton

| | | | |
|----------------------|----------------------------|------------------|--|
| 60W LED STREET LIGHT | | YOUR LOGO® | |
| Product Part #: | | xxxxxxx | |
| Power: 60W | Input:100-240V AC, 50-60Hz | Protection: IP66 | |

Stick Label of Lamp Body

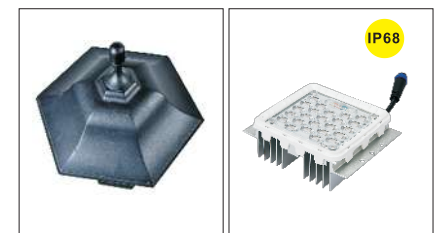

Top Viewing of Lamp

SCHTLITE LIGHT CO., LIMITED

Office and Factory
 #49, Changxin Road, Yuyao City ,Ningbo Of Zhejiang ,China
 Tel: +86-574-62805278 Fax: +86-574-62805277
 Email : sales@schtlite.com

service at alibaba.com
 we have our website at alibaba.com
 for all of our outdoor series of lighting
 with the page :
peterlamps.en.alibaba.com



LED 路灯 STREET LIGHT

Lighting Distribution:(optional)

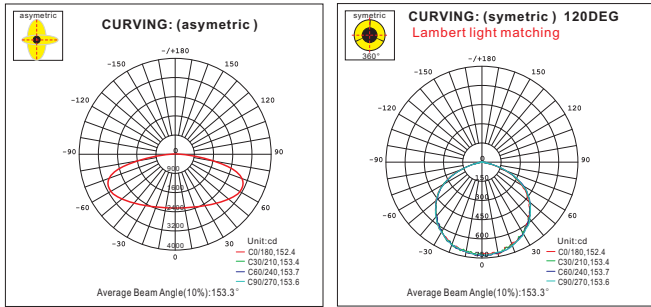

HISPALIS

西帕里斯

LETTUCE

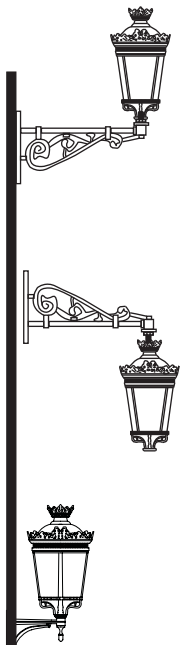

CABBAGE



HISPALIS

She is comprised of a spun aluminum body topped by a cast aluminum alloy support and a transparent polycarbonate protector.

It is equipped with a long-term Ip65 optical compartment, characterised by a reflector sealed to the protector and by unique access via the lamp holder supporting plug fitted with a short gasket.



MACUBA.S

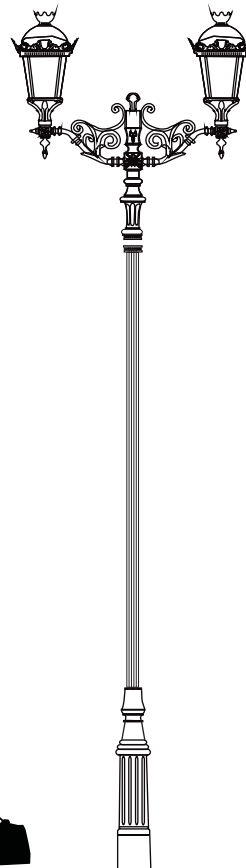

MACUBA.D

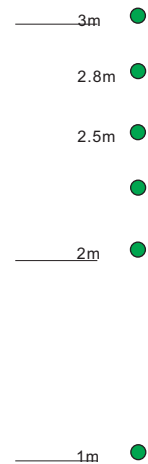

Ground Level

For installation of DQR.LED/MA Street Light -Vertical Mounted Type
 Model : PL30470HSP.880/Q1 , PL50470HSP.880/Q1



The photograph may not match the reference exactly. Please to read the product description to identify the finish .

LED3030 ≥ 105lm±5/W

- PL30470HSP.880W30/Q1
- PL30470HSP.880W40/Q1
- PL30470HSP.880W50/Q1
- PL30470HSP.880W60/Q1

LED5050 ≥ 130lm±5/W (high efficiency)

- PL50470HSP.880W30/Q1
- PL50470HSP.880W40/Q1
- PL50470HSP.880W50/Q1
- PL50470HSP.880W60/Q1

Lighting Distribution:(optional)

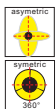

CURVING: (asymmetric)



CURVING: (symetric) 120DEG Lambert light matching

Box Size/Unit : 50*50*51cm

Gross Weight (kg) : 7.25Kg/1PC



DESCRIPTION:

Street of top post designed for vertical installation. Aluminum body and anti-Shock & UV PC diffuser from LED Module ,which is in high-strength without broken .

LED is made of PHILIPS Lumileds 3030 & 5050. Available in various finishes : white , grey, black , etc.,

TECHNICAL CHARACTERISTICS:

Type: LED Street- Top Post Mounted
 IP Protection degrees: IP68 (LED PART)
 Safety Class : Class-I
 Working Temperature : -25 ~ +50°C
 Voltage/Frequency : 220-240V ,50/60HZ
 100-275V ,50/60HZ



LED SPECIFICATIONS: (Q1,105lm±5/W /LED3030)

| | |
|---|---|
| Item No.: PL30470HSP.880W30/Q1 | Item No.: PL30470HSP.880W40/Q1 |
| LEDs: Phillips Lumileds 3030 35LEDs,30W | LEDs: Phillips Lumileds 3030 45LEDs,40W |
| Item No.: PL30470HSP.880W50/Q1 | Item No.: PL30470HSP.880W60/Q1 |
| LEDs: Phillips Lumileds 3030 49LEDs,50W | LEDs: Phillips Lumileds 3030 63LEDs,60W |

LED SPECIFICATIONS: (Q1,135lm±5/W /LED5050,high efficiency)

| | |
|---|---|
| Item No.: PL50470HSP.880W30/Q1 | Item No.: PL50470HSP.880W40/Q1 |
| LEDs: Phillips Lumileds 5050 14LEDs,30W | LEDs: Phillips Lumileds 5050 14LEDs,40W |
| Item No.: PL50470HSP.880W50/Q1 | Item No.: PL50470HSP.880W60/Q1 |
| LEDs: Phillips Lumileds 5050 18LEDs,50W | LEDs: Phillips Lumileds 5050 18LEDs,60W |



MATERIALS/FINISHES:

Structure material: Die-casting aluminium
Structure finish: Grey, White, Black, Silver

Diffuser Material: Anti-UV PC/Polycarbonate

SAMPLE FOR STICK LABELS:

Product Description **YOUR LOGO®**

60W LED STREET LIGHT

| | |
|---|---------------------------|
| Color Temp 3000K | Protection IP66 |
| Power Supply 100-240V AC, 50-60Hz | Power Rate 60W |
| Product Part #: xxxxxxx | |

#9, Changxin Road, Yuyao City, Ningbo Of Zhejiang ,China

Stick Label of box & carton

60W LED STREET LIGHT **YOUR LOGO®**

Product Part #: xxxxxxx

| | | |
|------------|----------------------------|------------------|
| Power: 60W | Input:100-240V AC, 50-60Hz | Protection: IP66 |
|------------|----------------------------|------------------|

Stick Label of Lamp Body

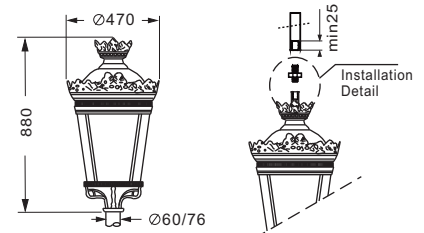

Energy Consumption Lable

SCHTLITE LIGHT CO., LIMITED

Office and Factory
 #777, Huan cheng Rd, Yuyao City ,Ningbo Of Zhejiang ,China
 Tel: +86-574-62805278 Fax: +86-574-62805277
 Email : sales@schtlite.com

service at alibaba.com
 we have our website at alibaba.com for all of our outdoor series of lighting with the page :
peterlamps.en.alibaba.com



For installation of DQR.LED/MA Street Light -Vertical Mounted Type
 Model : PL30405HSP.715/Q1 , PL50405HSP.715/Q1



The photograph may not match the reference exactly. Please to read the product description to identify the finish .

LED3030 ≥ 105lm±5/W

- PL30405HSP.715W30/Q1
- PL30405HSP.715W40/Q1
- PL30405HSP.715W50/Q1
- PL30405HSP.715W60/Q1

LED5050 ≥ 130lm±5/W (high efficiency)

- PL50405HSP.715W30/Q1
- PL50405HSP.715W40/Q1
- PL50405HSP.715W50/Q1
- PL50405HSP.715W60/Q1

Lighting Distribution:(optional)

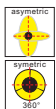

CURVING: (asymmetric)

CURVING: (symetric) 120DEG Lambert light matching

Box Size/Unit : 50*50*51cm

Gross Weight (kg) : 7.25Kg/1PC



Viewing of connector



Viewing of LED Module

DESCRIPTION:

Street of top post designed for vertical installation. Aluminum body and anti-Shock & UV PC diffuser from LED Module ,which is in high-strength without broken .

LED is made of PHILIPS Lumileds 3030 & 5050. Available in various finishes : white , grey, black , etc.,

TECHNICAL CHARACTERISTICS:

Type: LED Street- Top Post Mounted
 IP Protection degrees: IP68 (LED PART)
 Safety Class : Class-I
 Working Temperature : -25 ~ +50°C
 Voltage/Frequency : 220-240V ,50/60HZ
 100-275V ,50/60HZ



LED SPECIFICATIONS: (Q1,105lm±5/W /LED3030)

| | |
|---|---|
| Item No.: PL30405HSP.715W30/Q1 | Item No.: PL30405HSP.715W40/Q1 |
| LEDs: Phillips Lumileds 3030 35LEDs,30W | LEDs: Phillips Lumileds 3030 45LEDs,40W |
| Item No.: PL30405HSP.715W50/Q1 | Item No.: PL30405HSP.715W60/Q1 |
| LEDs: Phillips Lumileds 3030 49LEDs,50W | LEDs: Phillips Lumileds 3030 63LEDs,60W |

LED SPECIFICATIONS: (Q1,135lm±5/W /LED5050,high efficiency)

| | |
|---|---|
| Item No.: PL50405HSP.715W30/Q1 | Item No.: PL50405HSP.715W40/Q1 |
| LEDs: Phillips Lumileds 5050 14LEDs,30W | LEDs: Phillips Lumileds 5050 14LEDs,40W |
| Item No.: PL50405HSP.715W50/Q1 | Item No.: PL50405HSP.715W60/Q1 |
| LEDs: Phillips Lumileds 5050 18LEDs,50W | LEDs: Phillips Lumileds 5050 18LEDs,60W |



MATERIALS/FINISHES:

Structure material: Die-casting aluminium
Structure finish: Grey, White, Black, Silver

Diffuser Material: Anti-UV PC/Polycarbonate

SAMPLE FOR STICK LABELS:

Product Description **YOUR LOGO®**

60W LED STREET LIGHT

| | |
|---|---------------------------|
| Color Temp 3000K | Protection IP66 |
| Power Supply 100-240V AC, 50-60Hz | Power Rate 60W |

Product Part #: xxxxxxxx

+86 574 62805278
 +86 574 62805277
 sales@schtlite.com
 www.schtlite.com

#9, Changxin Road, Yuyao City, Ningbo Of Zhejiang ,China

Stick Label of box & carton

60W LED STREET LIGHT **YOUR LOGO®**

Product Part #: xxxxxxxx

| | | |
|------------|----------------------------|------------------|
| Power: 60W | Input:100-240V AC, 50-60Hz | Protection: IP66 |
|------------|----------------------------|------------------|

Stick Label of Lamp Body

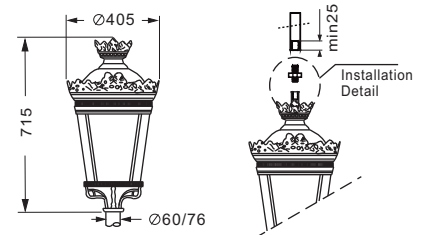

Energy Consumption Lable

SCHTLITE LIGHT CO., LIMITED

Office and Factory
 #777, Huan cheng Rd, Yuyao City ,Ningbo Of Zhejiang ,China
 Tel: +86-574-62805278 Fax: +86-574-62805277
 Email : sales@schtlite.com

service at alibaba.com
 we have our website at alibaba.com for all of our outdoor series of lighting with the page :
peterlamps.en.alibaba.com



LED 路灯 STREET LIGHT

Lighting Distribution:(optional)

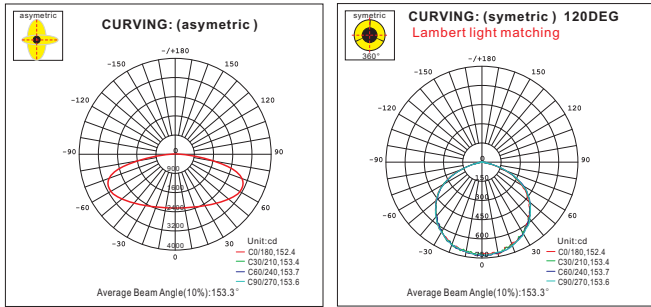

ISLA

島

ISLA.LED

Street of top post designed for vertical installation. Die casting aluminum body with spun aluminum top cover, and anti-Shock & UV PC diffuser from LED Module, which is in high-strength without broken.

LED is made of PHILIPS Lumileds 3030 or 5050(high efficiency). Available in various finishes : white , grey , black , etc.,

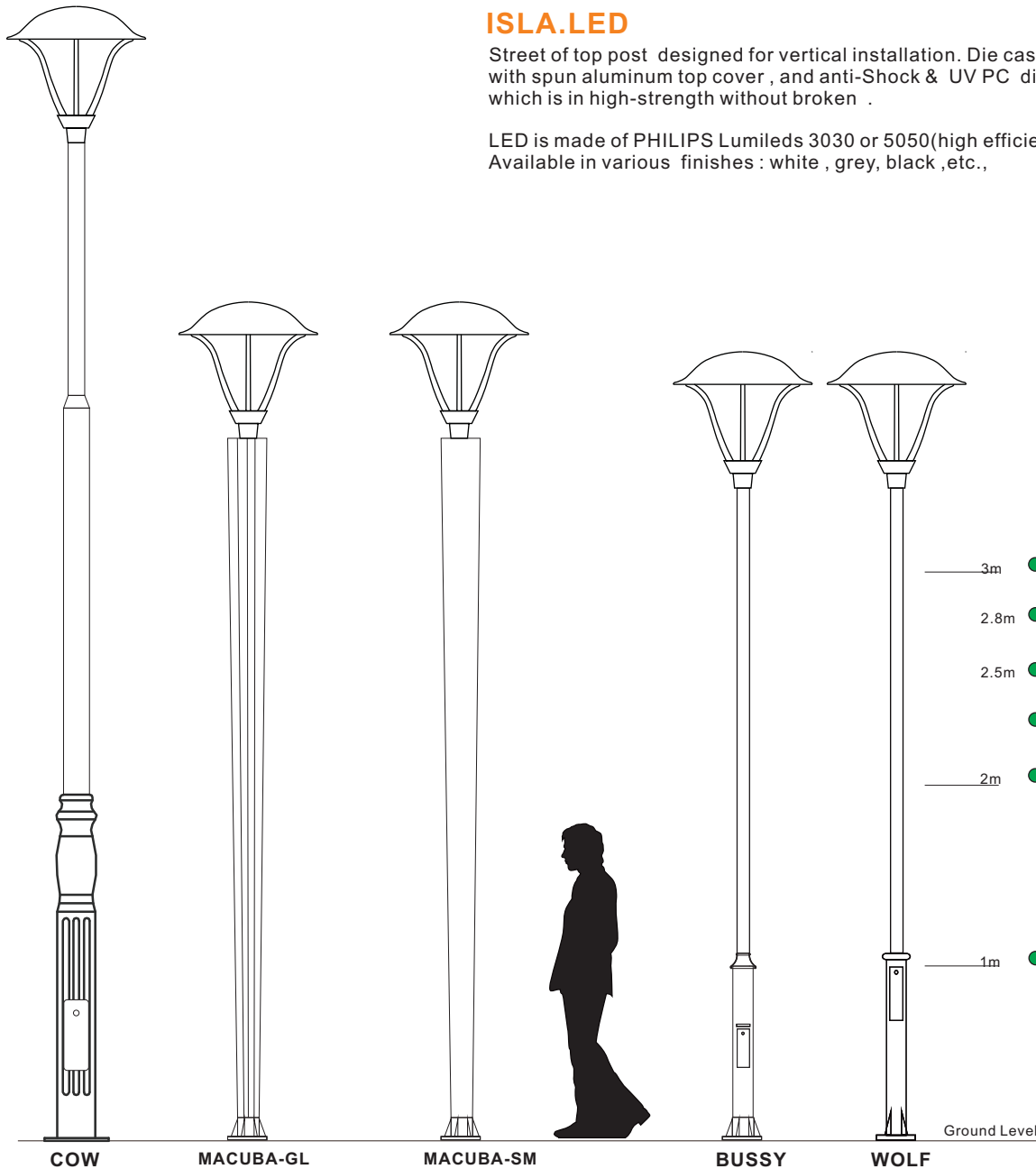

For installation of LED Module/Q Street Light -Vertical Mounted Type
 Model : PL30650ISL.674/Q1 , PL50650ISL.674/Q1

IP66



The photograph may not match the reference exactly. Please to read the product description to identify the finish .

LED3030 ≥105lm±5/W

- PL30650ISL.674W30/Q1
- PL30650ISL.674W40/Q1
- PL30650ISL.674W50/Q1
- PL30650ISL.674W60/Q1

LED5050 ≥130lm±5/W
(high efficiency)

- PL50650ISL.674W30/Q1
- PL50650ISL.674W40/Q1
- PL50650ISL.674W50/Q1
- PL50650ISL.674W60/Q1

Lighting Distribution:(optional)

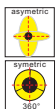

CURVING: (asymetric)

CURVING: (symetric) 120DEG
Lambert light matching

Box Size/Unit : 79*69*24cm

Gross Weight (kg) : 11.2Kg/1PC



Outlook Viewing



Viewing of LED Module



Outlook Viewing



Viewing of LED Module

DESCRIPTION:

Street of top post designed for vertical installation. Aluminum body and anti-Shock & UV PC diffuser from LED Module ,which is in high-strength without broken .

LED is made of PHILIPS Lumileds 3030 or 5050 (high efficiency).

TECHNICAL CHARACTERISTICS:

| | |
|------------------------|---------------------------------------|
| Type: | LED Street- Top Post Mounted |
| IP Protection degrees: | IP68 (LED PART) |
| Safety Class : | Class-I |
| Working Temperature : | -40 ~ +50℃ |
| Voltage/Frequency : | 120-240V ,50/60HZ 90-277V ,50/60HZ |



LED SPECIFICATIONS: (Q1, ≥105lm±5/W /LED3030)

| | |
|---|---|
| Item No.: PL30650ISL.674W30/Q1 | Item No.: PL30650ISL.674W40/Q1 |
| LEDs: Phillips Lumileds 3030 35LEDs,30W | LEDs: Phillips Lumileds 3030 45LEDs,40W |
| Item No.: PL30650ISL.674W50/Q1 | Item No.: PL30650ISL.674W60/Q1 |
| LEDs: Phillips Lumileds 3030 49LEDs,50W | LEDs: Phillips Lumileds 3030 63LEDs,60W |

LED SPECIFICATIONS: (Q1, ≥135lm±5/W /LED5050,high efficiency)

| | |
|---|---|
| Item No.: PL50650ISL.674W30/Q1 | Item No.: PL50650ISL.674W40/Q1 |
| LEDs: Phillips Lumileds 5050 14LEDs,30W | LEDs: Phillips Lumileds 5050 14LEDs,40W |
| Item No.: PL50650ISL.674W50/Q1 | Item No.: PL50650ISL.674W60/Q1 |
| LEDs: Phillips Lumileds 5050 18LEDs,50W | LEDs: Phillips Lumileds 5050 18LEDs,60W |

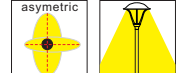

MATERIALS/FINISHES:

Structure material: Die-casting aluminium
 Structure finish: Grey, White, Black, Silver

Diffuser Material:
 Anti-UV PC/Polycarbonate

SAMPLE FOR STICK LABELS:

Product Description **YOUR LOGO®**

60W LED STREET LIGHT

| | |
|---|---------------------------|
| Color Temp 3000K | Protection IP66 |
| Power Supply 100-240V AC, 50-60Hz | Power Rate 60W |
| Product Part #: xxxxxxxx | |

☎ +86 574 62805278
 ☎ +86 574 62805277
 ✉ sales@schtlite.com
 www.schtlite.com

CLASS I, EEC A, IP66, IK 08, CE

#49, Changxin Road, Yuyao City, Ningbo Of Zhejiang ,China

Stick Label of box & carton

60W LED STREET LIGHT **YOUR LOGO®**

Product Part #: xxxxxxxx

| | | |
|------------|----------------------------|------------------|
| Power: 60W | Input:100-240V AC, 50-60Hz | Protection: IP66 |
|------------|----------------------------|------------------|

Stick Label of Lamp Body

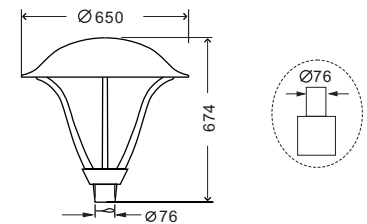

Dimensions (mm)

SCHTLITE LIGHT CO., LIMITED

Office and Factory
 #49, Changxin Road, Yuyao City, Ningbo Of Zhejiang ,China
 Tel: +86-574-62805278 Fax: +86-574-62805277
 Email : sales@schtlite.com

service at alibaba.com
 we have our website at alibaba.com
 for all of our outdoor series of lighting
 with the page :
peterlamps.en.alibaba.com



For installation of LED Module/LQ Street Light -Vertical Mounted Type
 Model : PL30650ISL.674/LQ , PL50650ISL.674/LQ

IP66



The photograph may not match the reference exactly. Please to read the product description to identify the finish .

LED3030 ≥105lm±5/W

- PL30690ISL.480W80/LQ2
- PL30690ISL.480W100/LQ2
- PL30690ISL.480W120/LQ2

LED5050 ≥130lm±5/W
(high efficiency)

- PL50690ISL.480W80/LQ2
- PL50690ISL.480W100/LQ2
- PL50690ISL.480W120/LQ2

Box Size/Unit : 79*69*24cm

Gross Weight (kg) : 11.2Kg/1PC

DESCRIPTION:

Street of top post designed for vertical installation. Aluminum body and anti-Shock & UV PC diffuser from LED Module , which is in high-strength without broken .

LED is made of PHILIPS Lumileds 3030 or 5050 (high efficiency).

TECHNICAL CHARACTERISTICS:

| | |
|------------------------|---------------------------------------|
| Type: | LED Street- Top Post Mounted |
| IP Protection degrees: | IP68 (LED PART) |
| Safety Class : | Class-I |
| Working Temperature : | -25 ~ +50℃ |
| Voltage/Frequency : | 120-240V ,50/60HZ 90-277V ,50/60HZ |



LED SPECIFICATIONS: (Q1, ≥105lm±5/W /LED3030)

| | | | |
|-----------|-------------------------------------|-----------|--------------------------------------|
| Item No.: | PL30650ISL.674W80/LQ2 | Item No.: | PL30650ISL.674W100/LQ2 |
| LEDs: | Phillips Lumileds 3030 3*45LEDs,80W | LEDs: | Phillips Lumileds 3030 2*63LEDs,100W |

| | |
|-----------|--------------------------------------|
| Item No.: | PL30650ISL.674W120/LQ2 |
| LEDs: | Phillips Lumileds 3030 2*63LEDs,120W |

3000K/4000K/5000K/5700K ,CRI≥70

LED SPECIFICATIONS: (Q1, ≥135lm±5/W /LED5050,high efficiency)

| | | | |
|-----------|-------------------------------------|-----------|--------------------------------------|
| Item No.: | PL50650ISL.674W80/LQ2 | Item No.: | PL50650ISL.674W100/LQ2 |
| LEDs: | Phillips Lumileds 5050 2*18LEDs,80W | LEDs: | Phillips Lumileds 5050 2*18LEDs,100W |

| | |
|-----------|--------------------------------------|
| Item No.: | PL50650ISL.674W120/LQ2 |
| LEDs: | Phillips Lumileds 5050 2*18LEDs,120W |

3000K/4000K/5000K/5700K ,CRI≥70



MATERIALS/FINISHES:

Structure material: Die-casting aluminum
 Structure finish: Grey, White, Black, Silver

Diffuser Material:
 Anti-UV PC/Polycarbonate

SAMPLE FOR STICK LABELS:

Product Description **YOUR LOGO®**
80W LED LED STREET LIGHT-COBRA

| | |
|---|---------------------------|
| Color Temp 4000K | Protection IP66 |
| Power Supply AC100-265V,50-60Hz | Power Rate 80W |

Product Part #: XXXXXXXX

+86 574 62805278
 +86 574 62805277
 sales@schtlite.com
 www.schtlite.com

#49, Changxin Road, Yuyao City, Ningbo Of Zhejiang, China

Details about LED Module

80W LED STREET LIGHT **YOUR LOGO®**
 Product Part #: xxxxxxxx

| | | |
|------------|----------------------------|------------------|
| Power: 80W | Input:100-240V AC, 50-60Hz | Protection: IP66 |
|------------|----------------------------|------------------|

Stick Label of Lamp Body

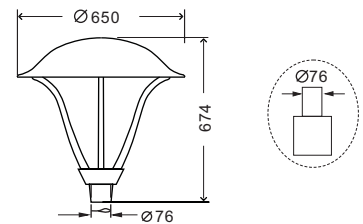

Dimensions (mm)

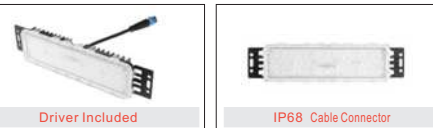

Lighting Distribution:(optional)

CURVING: (asymmetric)

CURVING: (symetric) 120DEG Lambert light matching

SCHTLITE LIGHT CO., LIMITED

Office and Factory
 #49, Changxin Road, Yuyao City, Ningbo Of Zhejiang, China
 Tel: +86-574-62805278 Fax: +86-574-62805277
 Email : sales@schtlite.com

service at alibaba.com
 we have our website at alibaba.com
 for all of our outdoor series of lighting
 with the page :
peterlamps.en.alibaba.com



For installation of LED Module/R Street Light -Vertical Mounted Type
Model : PL30650ISL.674/R

IP66



DESCRIPTION:

Street of top post designed for vertical installation. Aluminum body and anti-Shock & UV PC diffuser from LED Module ,which is in high-strength without broken .

LED is made of PHILIPS Lumileds 3030 or 5050 (high efficiency).

TECHNICAL CHARACTERISTICS:

| | |
|------------------------|---------------------------------------|
| Type: | LED Street- Top Post Mounted |
| IP Protection degrees: | IP68 (LED PART) |
| Safety Class : | Class-I |
| Working Temperature : | -40 ~ +50°C |
| Voltage/Frequency : | 120-240V ,50/60HZ 90-277V ,50/60HZ |



LED SPECIFICATIONS: (Q1, ≥105lm±5/W /LED3030, CRI≥70)

| | |
|--|--|
| Item No.: PL30650ISL.674W60/R3 | Item No.: PL30650ISL.674W80/R4 |
| LEDs: Phillips Lumileds 3030 3*24LEDs,60W | LEDs: Phillips Lumileds 3030 4*24LEDs,80W |
| LEDs : 3000/4000K/5700K, ≥105lm±5/W | LEDs: 3000/4000K/5700K, ≥105lm±5/W |
| Item No.: PL30650ISL.674W100/R5 | Item No.: PL30690ISL.674W120/R6 |
| LEDs: Phillips Lumileds 3030 5*24LEDs,100W | LEDs: Phillips Lumileds 3030 6*24LEDs,120W |
| LEDs : 3000/4000K/5700K, ≥105lm±5/W | LEDs :3000/4000K/5700K, ≥105lm±5/W |

| | |
|----------------------------|------------|
| Box Size/Unit : | 79*69*24cm |
| Gross Weight (kg) : | 11.2Kg/1PC |

3000K/4000K/5000K/5700K ,CRI≥70



MATERIALS/FINISHES:

Structure material: Die-casting aluminium
Structure finish: Grey, White, Black, Silver
Diffuser Material: Anti-UV PC/Polycarbonate

SAMPLE FOR STICK LABELS:

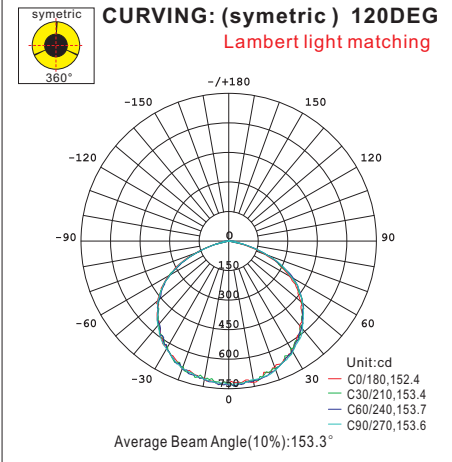

Product Description **YOUR LOGO®**

60W LED STREET LIGHT

| | |
|---|---------------------------|
| Color Temp 3000K | Protection IP66 |
| Power Supply 100-240V AC, 50-60Hz | Power Rate 60W |
| Product Part #: xxxxxxx | |

+86 574 62805278
+86 574 62805277
sales@schtlite.com
www.schtlite.com

#49, Changxin Road, Yuyao City, Ningbo Of Zhejiang ,China

60W LED STREET LIGHT YOUR LOGO®

Product Part #: xxxxxxx

| | | |
|------------|----------------------------|------------------|
| Power: 60W | Input:100-240V AC, 50-60Hz | Protection: IP66 |
|------------|----------------------------|------------------|

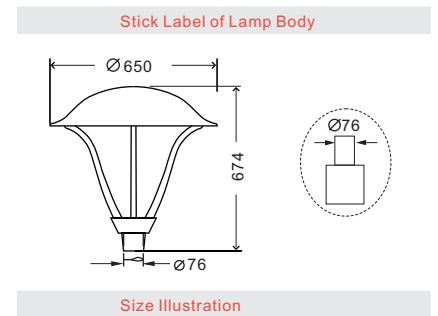

SCHTLITE LIGHT CO., LIMITED

Office and Factory
#49, Changxin Road, Yuyao City, Ningbo Of Zhejiang, China
Tel: +86-574-62805278 Fax: +86-574-62805277
Email: sales@schtlite.com

service at alibaba.com
we have our website at alibaba.com for all of our outdoor series of lighting with the page :
peterlamps.en.alibaba.com



LED 路灯 STREET LIGHT

Lighting Distribution:(optional)

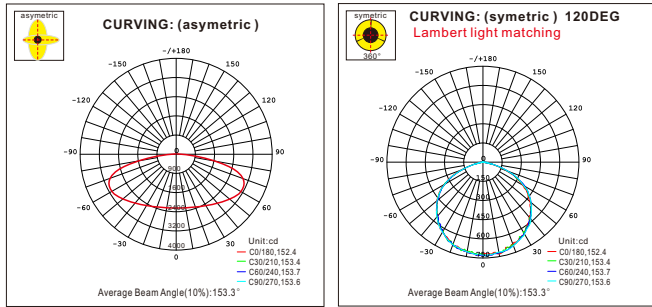

PISA 比萨

PISA.LED

Street of top post designed for vertical installation. Die casting Aluminum body and anti-Shock & UV PC diffuser, which is in high-strength without broken.

LED is made of PHILIPS Lumileds 3030 or 5050 (high efficiency). Available in various finishes : white , grey, black , etc.,

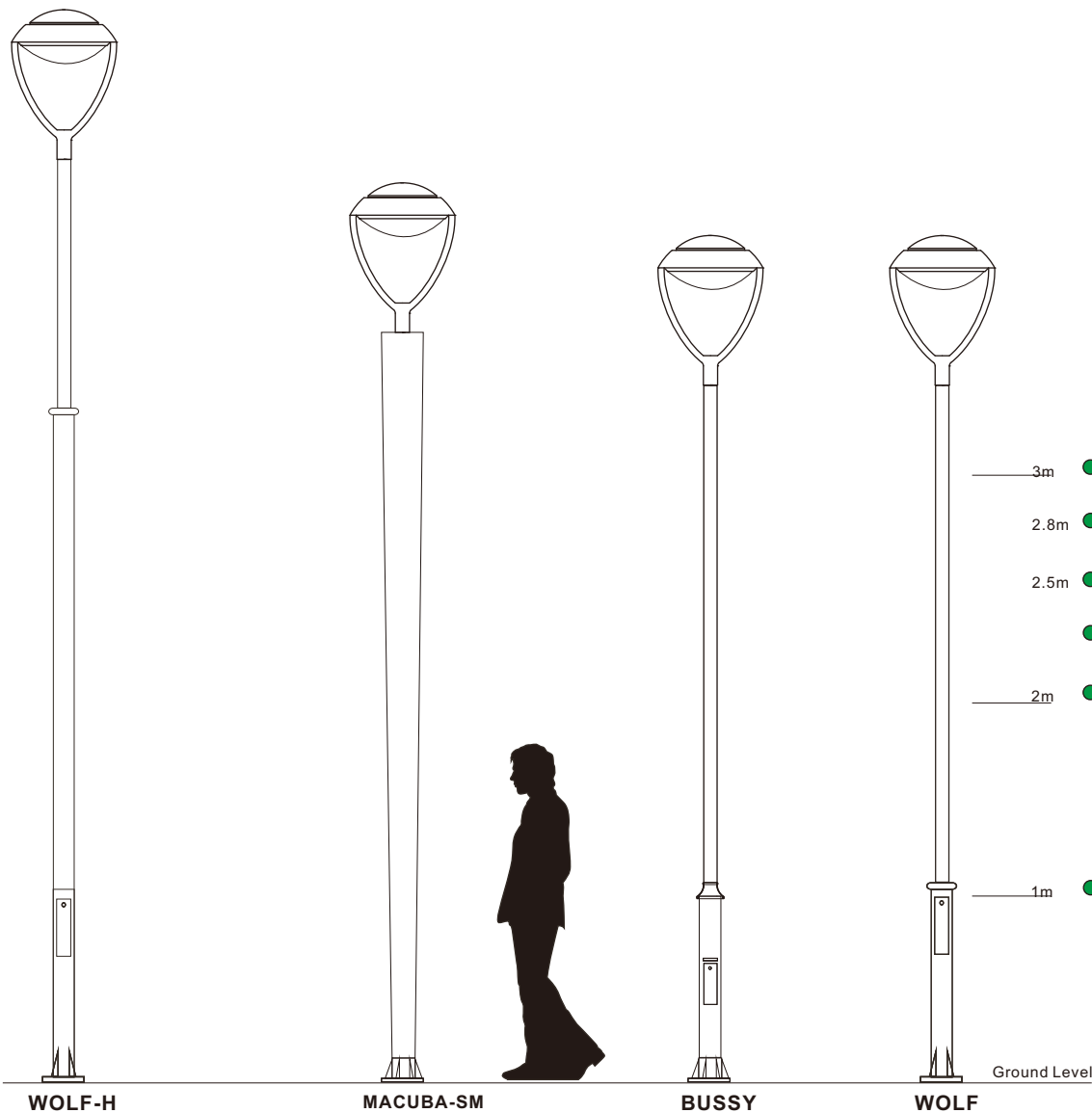

For installation of Street Light -Vertical Mounted Type

Model : PL30480PIS/B/Q1 , PL50480PIS/B/Q1

IP66



The photograph may not match the reference exactly. Please to read the product description to identify the finish .

LED3030 ≥ 105lm±5/W

- PL30480PIS/B30W/Q1
- PL30480PIS/B40W/Q1
- PL30480PIS/B50W/Q1
- PL30480PIS/B60W/Q1

LED5050 ≥ 130lm±5/W (high efficiency)

- PL50480PIS/B30W/Q1
- PL50480PIS/B40W/Q1
- PL50480PIS/B50W/Q1
- PL50480PIS/B60W/Q1

Lighting Distribution:(optional)

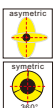

CURVING: (asymmetric)

CURVING: (symetric) 120DEG Lambert light matching

Box Size/Unit : ---cm

Gross Weight (kg) : ---Kg/1PC



DESCRIPTION:

Street of top post designed for vertical installation. Aluminum body and anti-Shock & UV PC diffuser from LED Module ,which is in high-strength without broken .

LED is made of PHILIPS Lumileds 3030 & 5050. Available in various finishes : white , grey, black , etc.,

TECHNICAL CHARACTERISTICS:

Type: LED Street- Top Post Mounted
 IP Protection degrees: IP68 (LED PART 60W)
 Safety Class : Class-I
 Working Temperature : -25 ~ +50°C
 Voltage/Frequency : 220-240V ,50/60HZ
 100-275V ,50/60HZ



LED SPECIFICATIONS: (Q1,105lm±5/W /LED3030)

| | |
|---|---|
| Item No.: PL30480PIS/B30W/Q1 | Item No.: PL30480PIS/B40W/Q1 |
| LEDs: Phillips Lumileds 3030 35LEDs,30W | LEDs: Phillips Lumileds 3030 45LEDs,40W |
| Item No.: PL30480PIS/B50W/Q1 | Item No.: PL30480PIS/B60W/Q1 |
| LEDs: Phillips Lumileds 3030 49LEDs,50W | LEDs: Phillips Lumileds 3030 63LEDs,60W |

LED SPECIFICATIONS: (Q1,135lm±5/W /LED5050,high efficiency)

| | |
|---|---|
| Item No.: PL50480PIS/B30W/Q1 | Item No.: PL50480PIS/B40W/Q1 |
| LEDs: Phillips Lumileds 5050 14LEDs,30W | LEDs: Phillips Lumileds 5050 14LEDs,40W |
| Item No.: PL50480PIS/B50W/Q1 | Item No.: PL50480PIS/B60W/Q1 |
| LEDs: Phillips Lumileds 5050 18LEDs,50W | LEDs: Phillips Lumileds 5050 18LEDs,60W |



MATERIALS/FINISHES:

Structure material: Die-casting aluminium
Structure finish: Grey, White, Black, Silver

Diffuser Material: Temper Glass

SAMPLE FOR STICK LABELS:

Product Description **YOUR LOGO®**

60W LED STREET LIGHT

| | |
|---|---------------------------|
| Color Temp 3000K | Protection IP66 |
| Power Supply 100-240V AC, 50-60Hz | Power Rate 60W |
| Product Part #: xxxxxxx | |

+86 574 62805278
 +86 574 62805277
 sales@schtlite.com
 www.schtlite.com

#49, Changxin Road, Yuyao City, Ningbo Of Zhejiang ,China

Stick Label of box & carton

60W LED STREET LIGHT **YOUR LOGO®**

Product Part #: xxxxxxx

| | | |
|------------|----------------------------|------------------|
| Power: 60W | Input:100-240V AC, 50-60Hz | Protection: IP66 |
|------------|----------------------------|------------------|

Stick Label of Lamp Body

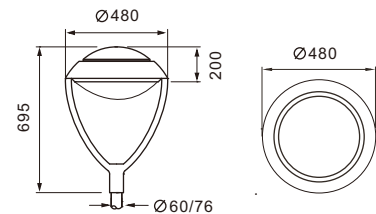

Size Illustrations

SCHTLITE LIGHT CO., LIMITED

Office and Factory
 #49, Changxin Road, Yuyao City ,Ningbo Of Zhejiang ,China
 Tel:+86-574-62805278 Fax:+86-574-62805277
 Email : sales@schtlite.com

service at alibaba.com
 we have our website at alibaba.com for all of our outdoor series of lighting with the page :
peterlamps.en.alibaba.com



For installation of Street Light -Vertical Mounted Type

Model : PL50480PIS/A , PL50480PIS/C

IP66



ST0480PIS/A.CG

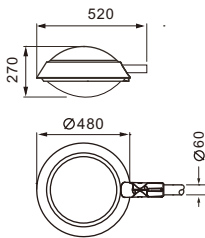

LED5050 ≥ 130lm±5/W
(high efficiency)

- PL50480PIS/A30W/Q1
- PL50480PIS/A40W/Q1
- PL50480PIS/A50W/Q1
- PL50480PIS/A60W/Q1

- PL50480PIS/A80W/LQ2
- PL50480PIS/A100W/LQ2
- PL50480PIS/A120W/LQ2

Lighting Distribution:(optional)

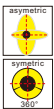

CURVING: (asymmetric)



CURVING: (symetric) 120DEG
Lambert light matching

Box Size/Unit : ---cm

Gross Weight (kg) : ---Kg/1PC



Viewing of connector



Viewing of LED Module

DESCRIPTION:

Street of top post designed for vertical installation. Aluminum body and anti-Shock & UV PC diffuser from LED Module ,which is in high-strength without broken .

LED is made of PHILIPS Lumileds 3030 & 5050.
Available in various finishes : white , grey, black , etc.,

TECHNICAL CHARACTERISTICS:

Type: LED Street- Top Post Mounted
 IP Protection degrees: IP68 (LED PART 60W)
 Safety Class : Class-I
 Working Temperature : -25 ~ +50°C
 Voltage/Frequency : 220-240V ,50/60HZ
 100-275V ,50/60HZ



LED SPECIFICATIONS: (Q1,135lm±5/W /LED5050,high efficiency)

Item No.: PL50480PIS/A30W/Q1 **Item No.:** PL50480PIS/A40W/Q1

LEDs: Phillips Lumileds 5050 14LEDs,30W LEDs: Phillips Lumileds 5050 14LEDs,40W

Item No.: PL50480PIS/A50W/Q1 **Item No.:** PL50480PIS/A60W/Q1

LEDs: Phillips Lumileds 5050 18LEDs,50W LEDs: Phillips Lumileds 5050 18LEDs,60W

LED SPECIFICATIONS: (LQ2,135lm±5/W /LED5050,high efficiency)

Item No.: PL50480PIS/A80W/LQ2 **Item No.:** PL50480PIS/A100W/LQ2

LEDs: Phillips Lumileds 5050 2x18LEDs,80W LEDs: Phillips Lumileds 5050 2x18LEDs,100W

Item No.: PL50480PIS/A120W/LQ2

LEDs: Phillips Lumileds 5050 2x18LEDs,120W



MATERIALS/FINISHES:

Structure material: Die-casting aluminium
Structure finish: Grey, White, Black, Silver

Diffuser Material:
Temper glass

SAMPLE FOR STICK LABELS:

Product Description **YOUR LOGO®**

60W LED STREET LIGHT

| | |
|---|---------------------------|
| Color Temp 3000K | Protection IP66 |
| Power Supply 100-240V AC, 50-60Hz | Power Rate 60W |
| Product Part #: xxxxxxxx | |

+86 574 62805278
 +86 574 62805277
 sales@schtlite.com
 www.schtlite.com

#49, Changxin Road, Yuyao City, Ningbo Of Zhejiang ,China

Stick Label of box & carton

60W LED STREET LIGHT **YOUR LOGO®**

Product Part #: xxxxxxxx

| | | |
|------------|----------------------------|------------------|
| Power: 60W | Input:100-240V AC, 50-60Hz | Protection: IP66 |
|------------|----------------------------|------------------|

Stick Label of Lamp Body



ST0480PIS/C.CG

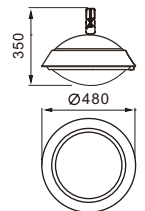

Size Illustrations

SCHTLITE LIGHT CO., LIMITED

Office and Factory
 #49, Changxin Road, Yuyao City, Ningbo Of Zhejiang ,China
 Tel:+86-574-62805278 Fax:+86-574-62805277
 Email : sales@schtlite.com

service at alibaba.com
 we have our website at alibaba.com
 for all of our outdoor series of lighting
 with the page :
peterlamps.en.alibaba.com



LED 路灯 STREET LIGHT



RAINFOREST

热带雨林

RAINFOREST

She is comprised of a spun aluminum body topped by a cast aluminum alloy support and a transparent polycarbonate protector.

It is equipped with a long-term Ip65 optical compartment, characterised by a reflector sealed to the protector and by unique access via the lamp holder supporting plug fitted with a short gasket.

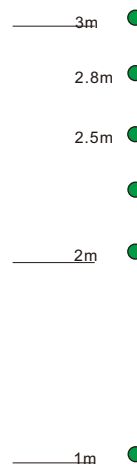
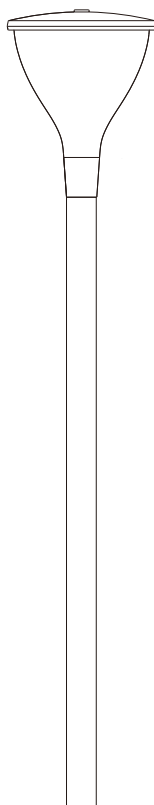

Ground Level



For installation of RAINFOREST Street Light -Vertical Mounted Type

Model : PT9560.710



PT9560RFT.710W35/16
PT9560RFT.710W45/20
PT9560RFT.710W55/24
PT9560RFT.710W60/28

The photograph may not match the reference exactly.
Please to read the product description to identify the finish.

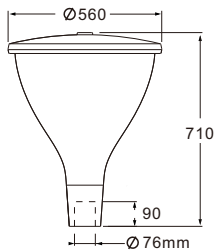

Driver Included



Top Viewing



DESCRIPTION:

Street of top post designed for vertical installation. Die casting aluminum body and anti-Shock & UV polyester/PC diffuser, which is in high-strength without broken.

Available in various finishes : white , grey, black , etc.,

TECHNICAL CHARACTERISTICS:

Type: LED Street- Top Post Mounted

IP/IK Protection degrees: IP65 / IK08

Safety Class : Class-I

Working Temperature : -25 °C ~ +50°C

Voltage/Frequency : 220-240V/100-240V ,50/60HZ



LED SPECIFICATIONS: (3000/4000K ,CRI≥70,85lm±5/W)

Item No.: **PT9560RFT.710W35/16** Item No.: **PT9560RFT.710W45/20**

LEDs: CREE 16LEDs, 35W

LEDs: CREE 20LEDs, 45W

Item No.: **PT9560RFT.710W55/24**

Item No.: **PT9560RFT.710W60/28**

LEDs: CREE 55LEDs, 24W

LEDs: CREE 28LEDs, 60W

Box Size/Unit : 60.5*60.5*76cm

Gross Weight (kg) : 13Kg/1PC

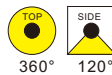

INVENTRONICS

MATERIALS/FINISHES:

Structure material: Die-casting aluminium
Structure finish: Grey, White, Black, Silver

Diffuser Material:
Anti-UV PC/Polycarbonate

SAMPLE FOR STICK LABELS:

Product Description **YOUR LOGO®**

60W LED STREET LIGHT

| | |
|---|---------------------------|
| Color Temp 3000K | Protection Ip65 |
| Power Supply 100-240V AC, 50-60Hz | Power Rate 60W |

Product Part #: xxxxxxx

+86 574 62805278
+86 574 62805277
sales@schtlite.com
www.schtlite.com

#49, Changxin Road, Yuyao City, Ningbo Of Zhejiang ,China

Stick Label of box & carton

60W LED STREET LIGHT **YOURLOGO®**

Product Part #: xxxxxxx

| | | |
|------------|----------------------------|------------------|
| Power: 60W | Input:100-240V AC, 50-60Hz | Protection: IP65 |
|------------|----------------------------|------------------|

Stick Label of Lamp Body

Not dimmable LED in warm white

A++ **A+** **A** **B** **C** **D** **E**

ENERGY STAR
енергия - енергетика

| | |
|------------|---------------------------|
| ≥70 | CRI |
| 2.7 | kwh/1000h |
| 90 degree | Beam Angle |
| 50W | Max LED Watt |
| 5700K | Color Temperature |
| 0%~95% | Environmental Humidity |
| 4250lm | Minimum luminous flux |
| -35°C~65°C | Environmental Temperature |

Energy Consumption Lable

SCHTLITE LIGHT CO., LIMITED

Office and Factory
#49, Changxin Road, Yuyao City, Ningbo Of Zhejiang ,China
Tel: +86-574-62805278 Fax: +86-574-62805277
Email : sales@schtlite.com

service at alibaba.com
we have our website at alibaba.com
for all of our outdoor series of lighting
with the page :
peterlamps.en.alibaba.com



For installation of Street Light -Vertical Mounted Type
Model : PL3340RVL , PL3340RVL/PC

IP65



PL3340RVL30W
PL3340RVL40W
PL3340RVL50W

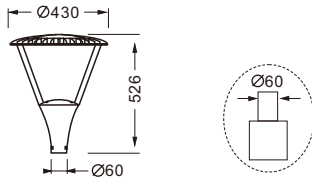

DESCRIPTION:

Street of top post designed for vertical installation. Aluminum body and anti-Shock & UV PC diffuser from LED Module ,which is in high-strength without broken .

LED is made of PHILIPS LUMILEDS 3030.
Available in various finishes : white , grey, black , etc.,

TECHNICAL CHARACTERISTICS:

Type: LED Street- Top Post
IP/IK Protection degrees: IP65/IK08
Safety Class : Class-I
Working Temperature : -25 ~ +50°C
Voltage/Frequency : 220-240V ,50/60HZ
100-275V ,50/60HZ



LED SPECIFICATIONS: (LED3030,CRI≥70)

| Item No.: | PL3430RVL30W PL3430RVL/PC30W | Item No.: | PL3430RVL50W PL3430RVL/PC50W |
|-----------|---------------------------------|-----------|---------------------------------|
| LEDs: | Phillips Lumileds 3030 ,30W | LEDs: | Phillips Lumileds 3030 ,50W |
| LEDs : | 3000K/4000K/5000K | LEDs : | 3000K/4000K/5000K |

Box Size/Unit : 50*50*51cm

Gross Weight (kg) : 7.25Kg/1PC



PL3430RVL/PC30W
PL3430RVL/PC40W
PL3430RVL/PC50W

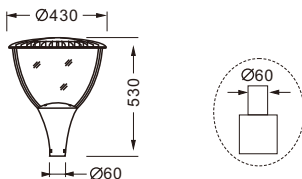

MATERIALS/FINISHES:

Structure material: Die-casting aluminium
Structure finish: Grey, White, Black, Silver

Diffuser Material:
Anti-UV PC/Polycarbonate

SAMPLE FOR STICK LABELS:

Product Description **YOUR LOGO®**
30W LED LED STREET LIGHT-VERTICAL

| | |
|---|---------------------------|
| Color Temp 4000K | Protection IP65 |
| Power Supply AC100-265V,50-60Hz | Power Rate 30W |

Product Part #: XXXXXXX

+86 574 62805278
+86 574 62805277
sales@schtlite.com
www.schtlite.com

#49, Changxin Road, Yuyao City, Ningbo Of Zhejiang, China

Stick Label of box & carton

30W LED LED STREET LIGHT-VERTICAL YOUR LOGO®
Product Part #: XXXXXXX

| | | |
|------------|---------------------------|------------------|
| Power: 30W | Input:100-265V AC,50-60Hz | Protection: IP65 |
|------------|---------------------------|------------------|

Stick Label of Lamp Body

ENERGY CLASS
энергия - эффективность

| | | | |
|--------------------------------|------------|---------------------------|------------------------|
| Not dimmable LED in warm white | A++ | ≥70 | CRI |
| | A+ | 2.7 | kwh/1000h |
| | A | 105 degree | Beam Angle |
| | B | 30W | Max LED Watt |
| | C | 4108K | Color Temperature |
| | D | 0%~95% | Environmental Humidity |
| E | 2305lm | Minimum luminous flux | |
| | -20°C~60°C | Environmental Temperature | |

Energy Consumption Lable

SCHTLITE LIGHT CO., LIMITED

Office and Factory
#49, Changxin Road, Yuyao City, Ningbo Of Zhejiang, China
Tel: +86-574-62805278 Fax: +86-574-62805277
Email: sales@schtlite.com

service at alibaba.com
we have our website at alibaba.com
for all of our outdoor series of lighting
with the page :
peterlamps.en.alibaba.com



LED 路灯 STREET LIGHT

Lighting Distribution:(optional)

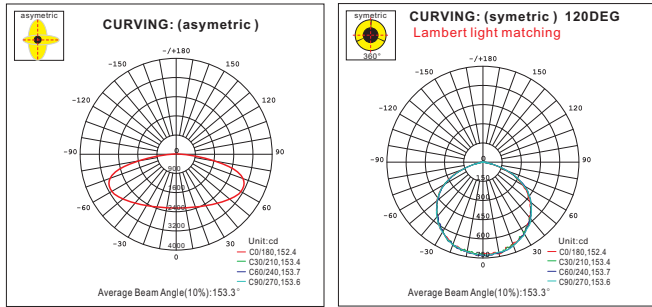

RUBY 红宝石

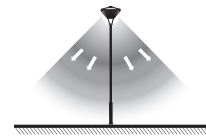

RUBY

She is comprised of a spun aluminum body topped by a cast aluminum alloy support and a transparent polycarbonate protector.

It is equipped with a long-term Ip65 optical compartment, characterised by a reflector sealed to the protector and by unique access via the lamp holder supporting plug fitted with a short gasket.

3m ●

2.8m ●

2.5m ●

2m ●

1m ●

Ground Level

WOLF-H

BUSSY

WOLF

LEOPARD

LED

CE

IK08

IP66

PHILIPS

MEAN WELL

INVENTRONICS

For installation of Street Light -Vertical Mounted Type
 Model : PL30520RUB.520/Q1 , PL50520RUB.520/Q1

IP66



The photograph may not match the reference exactly. Please to read the product description to identify the finish .

LED3030 ≥ 105lm±5/W

- PL30520RUB.520W30/Q1
- PL30520RUB.520W40/Q1
- PL30520RUB.520W50/Q1
- PL30520RUB.520W60/Q1

LED5050 ≥ 130lm±5/W
 (high efficiency)

- PL50520RUB.520W30/Q1
- PL50520RUB.520W40/Q1
- PL50520RUB.520W50/Q1
- PL50520RUB.520W60/Q1

Lighting Distribution:(optional)

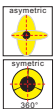

CURVING: (asymetric)

CURVING: (symetric) 120DEG
 Lambert light matching

IP68 LED Module
 3*20W standard

IP66

Box Size/Unit : 50*50*51cm

Gross Weight (kg) : 7.25Kg/1PC



Viewing of connector



Viewing of LED Module

DESCRIPTION:

Street of top post designed for vertical installation. Aluminum body and anti-Shock & UV PC diffuser from LED Module ,which is in high-strength without broken .

LED is made of PHILIPS Lumileds 3030 & 5050.
 Available in various finishes : white , grey, black , etc.,

TECHNICAL CHARACTERISTICS:

| | |
|------------------------|--|
| Type: | LED Street- Top Post Mounted |
| IP Protection degrees: | IP68 (LED PART 60W) |
| Safety Class : | Class-I |
| Working Temperature : | -25 ~ +50°C |
| Voltage/Frequency : | 220-240V ,50/60HZ 100-275V ,50/60HZ |



LED SPECIFICATIONS: (Q1,105lm±5/W /LED3030)

| | |
|---|---|
| Item No.: PL30520RUB.520W30/Q1 | Item No.: PL30520RUB.520W40/Q1 |
| LEDs: Phillips Lumileds 3030 35LEDs,30W | LEDs: Phillips Lumileds 3030 45LEDs,40W |
| Item No.: PL30520RUB.520W50/Q1 | Item No.: PL30520RUB.520W60/Q1 |
| LEDs: Phillips Lumileds 3030 49LEDs,50W | LEDs: Phillips Lumileds 3030 63LEDs,60W |

LED SPECIFICATIONS: (Q1,135lm±5/W /LED5050,high efficiency)

| | |
|---|---|
| Item No.: PL50520RUB.520W30/Q1 | Item No.: PL50520RUB.520W40/Q1 |
| LEDs: Phillips Lumileds 5050 14LEDs,30W | LEDs: Phillips Lumileds 5050 14LEDs,40W |
| Item No.: PL50520RUB.520W50/Q1 | Item No.: PL50520RUB.520W60/Q1 |
| LEDs: Phillips Lumileds 5050 18LEDs,50W | LEDs: Phillips Lumileds 5050 18LEDs,60W |



MATERIALS/FINISHES:

Structure material: Die-casting aluminium
Structure finish: Grey, White, Black, Silver

Diffuser Material:
 Anti-UV PC/Polycarbonate

SAMPLE FOR STICK LABELS:

Product Description **YOUR LOGO®**

60W LED STREET LIGHT

| | |
|---|---------------------------|
| Color Temp 3000K | Protection IP66 |
| Power Supply 100-240V AC, 50-60Hz | Power Rate 60W |

Product Part #: xxxxxxxx

+86 574 62805278
 +86 574 62805277
 sales@schtlite.com
 www.schtlite.com

#49, Changxin Road, Yuyao City, Ningbo Of Zhejiang ,China

Stick Label of box & carton

60W LED STREET LIGHT **YOUR LOGO®**

Product Part #: xxxxxxxx

| | | |
|------------|----------------------------|------------------|
| Power: 60W | Input:100-240V AC, 50-60Hz | Protection: IP66 |
|------------|----------------------------|------------------|

Stick Label of Lamp Body

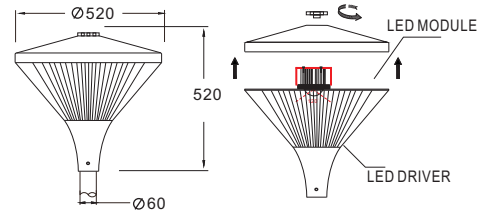

Size Illustrations

SCHTLITE LIGHT CO., LIMITED

Office and Factory
 #49, Changxin Road, Yuyao City ,Ningbo Of Zhejiang ,China
 Tel:+86-574-62805278 Fax:+86-574-62805277
 Email : sales@schtlite.com

service at alibaba.com
 we have our website at alibaba.com
 for all of our outdoor series of lighting
 with the page :
peterlamps.en.alibaba.com



For installation of Street Light -Vertical Mounted Type
 Model : PL30520RUB.520/R3 , PL30520RUB.520/R4

IP66 IP65



PL30520RUB.520W30/R3
 PL30520RUB.520W40/R4
 PL30520RUB.520W50/R3
 PL30520RUB.520W60/R3



DESCRIPTION:

Street of top post designed for vertical installation. Aluminum body and anti-Shock & UV PC diffuser from LED Module, which is in high-strength without broken.

LED is made of PHILIPS LUMILEDS 3030.
 Available in various finishes : white , grey, black , etc.,

TECHNICAL CHARACTERISTICS:

| | |
|------------------------|---|
| Type: | LED Street- Top Post Mounted |
| IP Protection degrees: | IP68 (LED PART) |
| Safety Class : | Class-I |
| Working Temperature : | -40 ~ +50°C |
| Voltage/Frequency : | 120-240V ,50/60HZ 100-277V ,50/60HZ 200-277V ,50/60HZ |



LED SPECIFICATIONS: ($\geq 105lm\pm 5/W$ /LED3030, CRI ≥ 70)

| | |
|--|---|
| Item No.: PL30520RUB.520W30/R3 | Item No.: PL30520RUB.520W40/R4 |
| LEDs: Phillips Lumileds 3030 3*10LEDs,30W | LEDs: Phillips Lumileds 3030 4*10LEDs,40W |
| LEDs : 3000K/4000K/500K/5700K, $\geq 105lm\pm 5/W$ | LEDs : 3000K/4000K/5000K/5700K, $\geq 105lm\pm 5/W$ |
| Item No.: PL30520RUB.520W50/R3 | Item No.: PL30520RUB.520W60/R3 |
| LEDs: Phillips Lumileds 3030 3*25LEDs,50W | LEDs: Phillips Lumileds 3030 3*24LEDs,60W |
| LEDs : 3000K/4000K/500K/5700K, $\geq 105lm\pm 5/W$ | LEDs : 3000K/4000K/5000K/5700K, $\geq 105lm\pm 5/W$ |

| | |
|----------------------------|------------|
| Box Size/Unit : | 47*47*47cm |
| Gross Weight (kg) : | 7.25Kg/1PC |

IP68 LED Module 3*20W standard **IP66**



MATERIALS/FINISHES:

Structure material: Die-casting aluminum
Structure finish: Grey, White, Black, Silver

Diffuser Material: Anti-UV PC/Polycarbonate

SAMPLE FOR STICK LABELS:

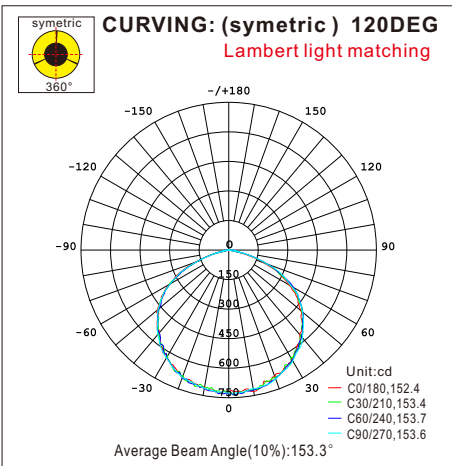

Product Description **YOUR LOGO®**
60W LED STREET LIGHT

| | |
|---|---------------------------|
| Color Temp 3000K | Protection IP66 |
| Power Supply 100-240V AC, 50-60Hz | Power Rate 60W |
| Product Part #: xxxxxxxx | |

#49, Changxin Road, Yuyao City, Ningbo Of Zhejiang ,China

60W LED STREET LIGHT **YOUR LOGO®**
 Product Part #: xxxxxxxx

| | | |
|------------|----------------------------|------------------|
| Power: 60W | Input:100-240V AC, 50-60Hz | Protection: IP66 |
|------------|----------------------------|------------------|

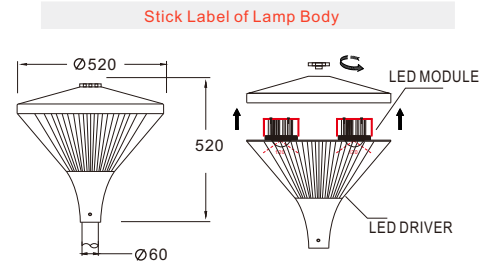

SCHTLITE LIGHT CO., LIMITED

Office and Factory
 #49, Changxin Road, Yuyao City, Ningbo Of Zhejiang ,China
 Tel: +86-574-62805278 Fax: +86-574-62805277
 Email : sales@schtlite.com

service at alibaba.com
 we have our website at alibaba.com for all of our outdoor series of lighting with the page :
peterlamps.en.alibaba.com



LED 路灯 STREET LIGHT

TOPEKA

托皮卡

TOPEKA

Access to the lamp and electrical control gear is obtained by loosening the two captive screws on the plug cover situated on the top cover of the luminaire.

After this operation, the cover plug swivels open on a hinge. If the electrical control gear plate is incorporated, it can be easily disconnected by loosening the two captive screws.

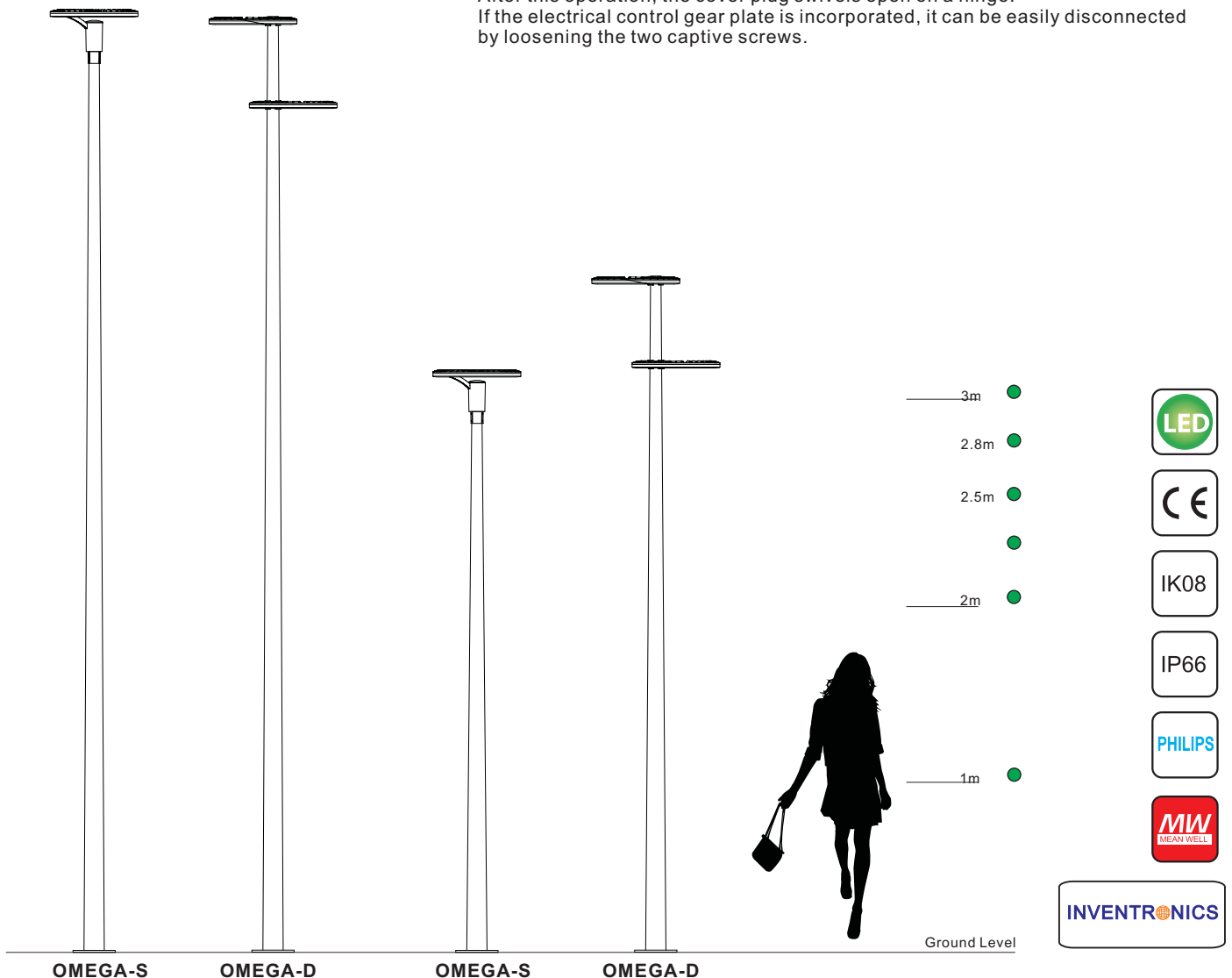

For installation of Street Light -Vertical Mounted Type
 Model : PL3520TPK.317 , SD3520TPK.317 , PL3520TPK.185

IP65



DESCRIPTION:

Street of top post designed for vertical installation. Aluminum body and anti-Shock & UV PC diffuser from LED Module ,which is in high-strength without broken .

LED is made of PHILIPS LUMILEDS 3030.
 Available in various finishes : white , grey, black , etc.,

TECHNICAL CHARACTERISTICS:

| | |
|---------------------------|--|
| Type: | LED Street- Top Post Mounted |
| IP/IK Protection degrees: | IP65/IK08 |
| Safety Class : | Class-I |
| Working Temperature : | -25 ~ +50°C |
| Voltage/Frequency : | 220-240V ,50/60HZ 100-275V ,50/60HZ |



PL3520TPK.317W30
 PL3520TPK.317W45
 PL3520TPK.317W60
 PL3520TPK.317W80

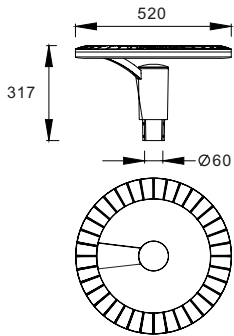

SD3520TPK.317W30
 SD3520TPK.317W45
 SD3520TPK.317W60
 SD3520TPK.317W80

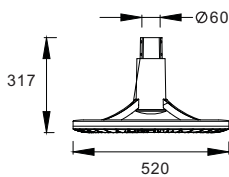

PL3520TPK.185W30
 PL3520TPK.185W45
 PL3520TPK.185W60
 PL3520TPK.185W80

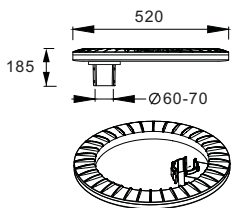

LED SPECIFICATIONS: (LED3030,CRI≥70)

| | | | |
|------------------|---|------------------|---|
| Item No.: | PL3520TPK.317W30 SD3520TPK.317W30 PL3520TPK.185W30 | Item No.: | PL3520TPK.317W45 SD3520TPK.317W45 PL3520TPK.185W45 |
| LEDs: | Phillips Lumileds 3030 ,30W | LEDs: | Phillips Lumileds 3030 ,45W |
| LEDs : | 3000K/4000K,2305lm , 104.19 DEG | LEDs : | 3000K/4000K,3325lm , 104.19 DEG |
| Item No.: | PL3520TPK.317W60 SD3520TPK.317W60 PL3520TPK.185W60 | Item No.: | PL3520TPK.317W80 SD3520TPK.317W80 PL3520TPK.185W80 |
| LEDs: | Phillips Lumileds 3030 ,30W | LEDs: | Phillips Lumileds 3030 ,45W |
| LEDs : | 3000K/4000K,4490lm , 104.19 DEG | LEDs : | 3000K/4000K,5044lm , 104.19 DEG |

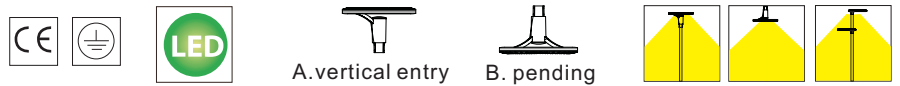

MATERIALS/FINISHES:

Structure material: Die-casting aluminium
Structure finish: Grey, White, Black, Silver

Diffuser Material:
 Anti-UV PC/Polycarbonate

SAMPLE FOR STICK LABELS:

Product Description **YOUR LOGO®**

30W LED LED STREET LIGHT-VERTICAL

| | |
|---|---------------------------|
| Color Temp 4000K | Protection IP65 |
| Power Supply AC100-265V,50-60Hz | Power Rate 30W |

Product Part #: XXXXXXX

+86 574 62805278
 +86 574 62805277
 sales@schtlite.com
 www.schtlite.com

#49, Changxin Road, Yuyao City, Ningbo Of Zhejiang, China

Stick Label of box & carton

30W LED LED STREET LIGHT-VERTICAL YOUR LOGO®

Product Part #: XXXXXXX

| | | |
|------------|---------------------------|------------------|
| Power: 30W | Input:100-265V AC,50-60Hz | Protection: IP65 |
|------------|---------------------------|------------------|

Stick Label of Lamp Body

ENERGY CLASSIFICATION

LED in warm white

| | | |
|---------------------------|------------|---------------------------|
| Energy Class | ≥70 | CRI |
| Power | 2.7 | kwh/1000h |
| Beam Angle | 105 degree | Beam Angle |
| Max LED Watt | 30W | Max LED Watt |
| Color Temperature | 4108K | Color Temperature |
| Environmental Humidity | 0%~95% | Environmental Humidity |
| Minimum luminous flux | 2305lm | Minimum luminous flux |
| Environmental Temperature | -20°C~60°C | Environmental Temperature |

Energy Consumption Lable

SCHTLITE LIGHT CO., LIMITED

Office and Factory
 #49, Changxin Road, Yuyao City, Ningbo Of Zhejiang, China
 Tel: +86-574-62805278 Fax: +86-574-62805277
 Email : sales@schtlite.com

service at alibaba.com
 we have our website at alibaba.com
 for all of our outdoor series of lighting
 with the page :
peterlamps.en.alibaba.com



LED 路灯 STREET LIGHT

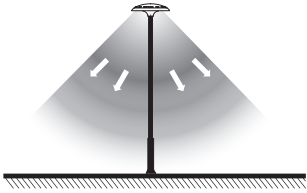

UFO.X

飞碟

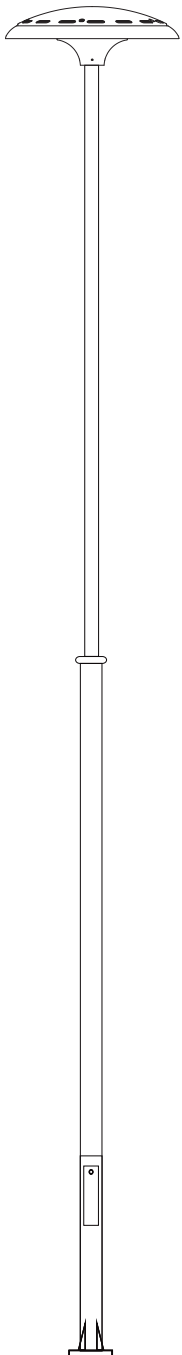

WOLF-H



UFO.X/IP66

Street of top post designed for vertical installation. Spun Aluminum body and anti-Shock & UV PC diffuser from LED Module ,which is in high-strength without broken .

LED is made of PHILIPS Lumileds 3030.
Available in various finishes : white , grey, black , etc.,



UFO.X/IP65

Street of top post designed for vertical installation. Die cast Aluminum body and anti-Shock & UV PC diffuser ,which is in high-strength without broken .

LED is made of LG.
Available in various finishes : white , grey, black , etc.,

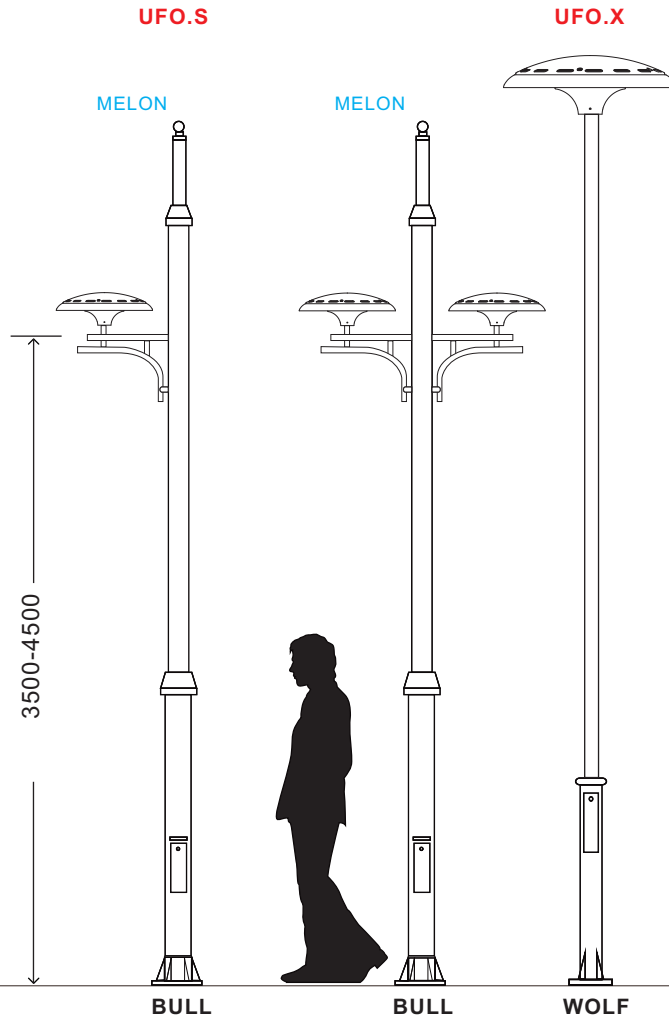

BULL

BULL

WOLF



For installation of Street Light -Vertical Mounted Type

Model : PL30650UFO.310

IP66



PL30650UFO.310W60/R3
 PL30650UFO.310W80/R4
 PL30650UFO.310W100/R5
 PL30650UFO.310W120/R6

The photograph may not match the reference exactly.
 Please to read the product description to identify the finish.

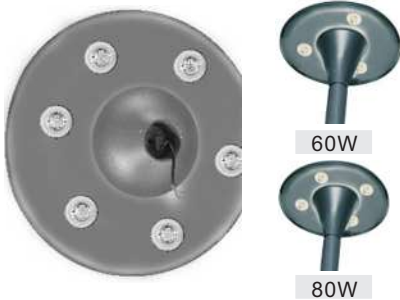
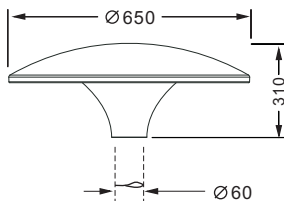

Module Units For Watts Optional



Inner Side Viewing of 80W

DESCRIPTION:

Street of top post designed for vertical installation. Spun Aluminum body and anti-Shock & UV PC diffuser from LED Module, which is in high-strength without broken.

LED is made of PHILIPS Lumileds 3030.
 Available in various finishes : white , grey, black , etc.,

TECHNICAL CHARACTERISTICS:

Type: LED Street- Top Post Mounted
 IP Protection degrees: IP68 (LED PART)
 Safety Class : Class-I
 Working Temperature : -25 ~ +50°C
 Voltage/Frequency : 220-240V ,50/60HZ
 100-275V ,50/60HZ

Box Size/Unit : 69*69*35cm

Gross Weight (kg) : 10.2Kg/1PC



LED SPECIFICATIONS: (Q1, ≥105lm±5/W /LED3030,CRI≥70)

| | |
|--|--|
| Item No.: PL30650UFO.310W60/R3 | Item No.: PL30650UFO.310W80/R4 |
| LEDs: Phillips Lumileds 3030 3*24LEDs,60W | LEDs: Phillips Lumileds 3030 4*24LEDs,80W |
| LEDs : 3000/4000K/5700K, ≥105lm±5/W | LEDs: 3000/4000K/5700K, ≥105lm±5/W |
| Item No.: PL30650UFO.310W100/R5 | Item No.: PL30650UFO.310W120/R6 |
| LEDs: Phillips Lumileds 3030 5*24LEDs,100W | LEDs: Phillips Lumileds 3030 6*24LEDs,120W |
| LEDs : 3000/4000K/5700K, ≥105lm±5/W | LEDs :3000/4000K/5700K, ≥105lm±5/W |



MATERIALS/FINISHES:

Structure material: Die-casting aluminium
Structure finish: Grey, White, Black, Silver

Diffuser Material:
 Anti-UV PC/Polycarbonate

SAMPLE FOR STICK LABELS:

Product Description **YOUR LOGO®**

60W LED STREET LIGHT

| | |
|---|---------------------------|
| Color Temp 3000K | Protection IP66 |
| Power Supply 100-240V AC, 50-60Hz | Power Rate 60W |

Product Part #: xxxxxxxx

+86 574 62805278
 +86 574 62805277
 sales@schtlite.com
 www.schtlite.com

#49, Changxin Road, Yuyao City, Ningbo Of Zhejiang ,China

Stick Label of box & carton

60W LED STREET LIGHT YOUR LOGO®

Product Part #: xxxxxxxx

| | | |
|------------|----------------------------|------------------|
| Power: 60W | Input:100-240V AC, 50-60Hz | Protection: IP66 |
|------------|----------------------------|------------------|

Stick Label of Lamp Body

Not dimmable LED in warm white

ENERGY STAR энергия - everywhere

| | |
|------------|---------------------------|
| ≥70 | CRI |
| 2.7 | kwh/1000h |
| 120 degree | Beam Angle |
| 60W | Max LED Watt |
| 5700K | Color Temperature |
| 0%~95% | Environmental Humidity |
| 5088lm | Minimum luminous flux |
| -35°C~65°C | Environmental Temperature |

Size Illustration

SCHTLITE LIGHT CO., LIMITED

Office and Factory
 #49, Changxin Road, Yuyao City, Ningbo Of Zhejiang ,China
 Tel:+86-574-62805278 Fax:+86-574-62805277
 Email : sales@schtlite.com

service at alibaba.com
 we have our website at alibaba.com
 for all of our outdoor series of lighting
 with the page :
peterlamps.en.alibaba.com



For installation of Street Light -Vertical Mounted Type

Model : PL9650UFO

IP65



PL9650UFO40W
PL9650UFO60W
PL9650UFO80W

The photograph may not match the reference exactly.
Please to read the product description to identify the finish.

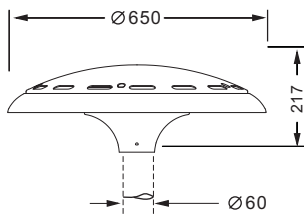

Made of Die Casting Aluminum



DESCRIPTION:

Street of top post designed for vertical installation. Die cast Aluminum body and anti-Shock & UV PC diffuser, which is in high-strength without broken.

LED is made of LG.

Available in various finishes : white , grey, black , etc.,

TECHNICAL CHARACTERISTICS:

Type: LED Street- Top Post Mounted
IP Protection degrees: IP65
Safety Class : Class-I
Working Temperature : -25 ~ +50°C
Voltage/Frequency : 220-240V ,50/60HZ
100-275V ,50/60HZ



LED SPECIFICATIONS:

| Item No.: | PL9650UFO40W | Item No.: | PL9650UFO60W |
|-----------|-----------------------------|--|-----------------------------|
| LEDs: | LG SMD 180LEDs,40W , 3800lm | LEDs: | LG SMD 180LEDs,60W , 5400lm |
| LEDs : | 3000K/4000K/5000K/6500K | LEDs: | 3000K/4000K/5000K/6500K |
| Item No.: | PL9650UFO80W | Box Size/Unit : 71*28.5*72.5cm Gross Weight (kg) : 10.5Kg/1PC | |
| LEDs: | LG SMD 180LEDs,80W , 6800lm | | |
| LEDs : | 3000K/4000K/5000K/6500K | | |

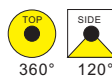

MATERIALS/FINISHES:

Structure material: Die-casting aluminium
Structure finish: Grey, White, Black, Silver

Diffuser Material:
Anti-UV PC/Polycarbonate

SAMPLE FOR STICK LABELS:

Product Description **YOUR LOGO®**

60W LED STREET LIGHT

| | |
|---|---------------------------|
| Color Temp 3000K | Protection IP66 |
| Power Supply 100-240V AC, 50-60Hz | Power Rate 60W |

Product Part #: xxxxxxxx

+86 574 62805278
+86 574 62805277
sales@schtlite.com
www.schtlite.com

#49, Changxin Road, Yuyao City, Ningbo Of Zhejiang ,China

Stick Label of box & carton

60W LED STREET LIGHT **YOUR LOGO®**

Product Part #: xxxxxxxx

| | | |
|------------|----------------------------|------------------|
| Power: 60W | Input:100-240V AC, 50-60Hz | Protection: IP66 |
|------------|----------------------------|------------------|

Stick Label of Lamp Body

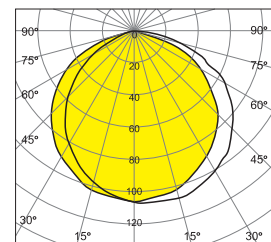

Mounting Height:
4m LED 50W

PHOTOMETRICS 50W

SCHTLITE LIGHT CO., LIMITED

Office and Factory
#49, Changxin Road, Yuyao City, Ningbo Of Zhejiang ,China
Tel: +86-574-62805278 Fax: +86-574-62805277
Email : sales@schtlite.com

service at alibaba.com
we have our website at alibaba.com
for all of our outdoor series of lighting
with the page :
peterlamps.en.alibaba.com



LED 路灯 STREET LIGHT

Lighting Distribution:(optional)

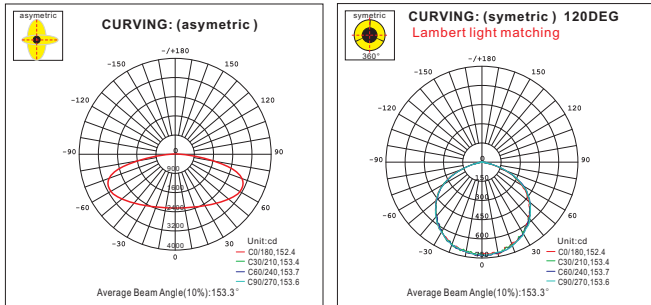

VALLENCAY

瓦伦塞

VALLENCAY425

Street of top post designed for vertical installation. Aluminum housing and spigot.

and the diffuser can be optional of below ,which both is in high-strength without broken .

1. anti-shock temper glass
2. of UV-stable PC

LED is made of PHILIPS LUMILEDS 3030 or 5050 (high efficiency).

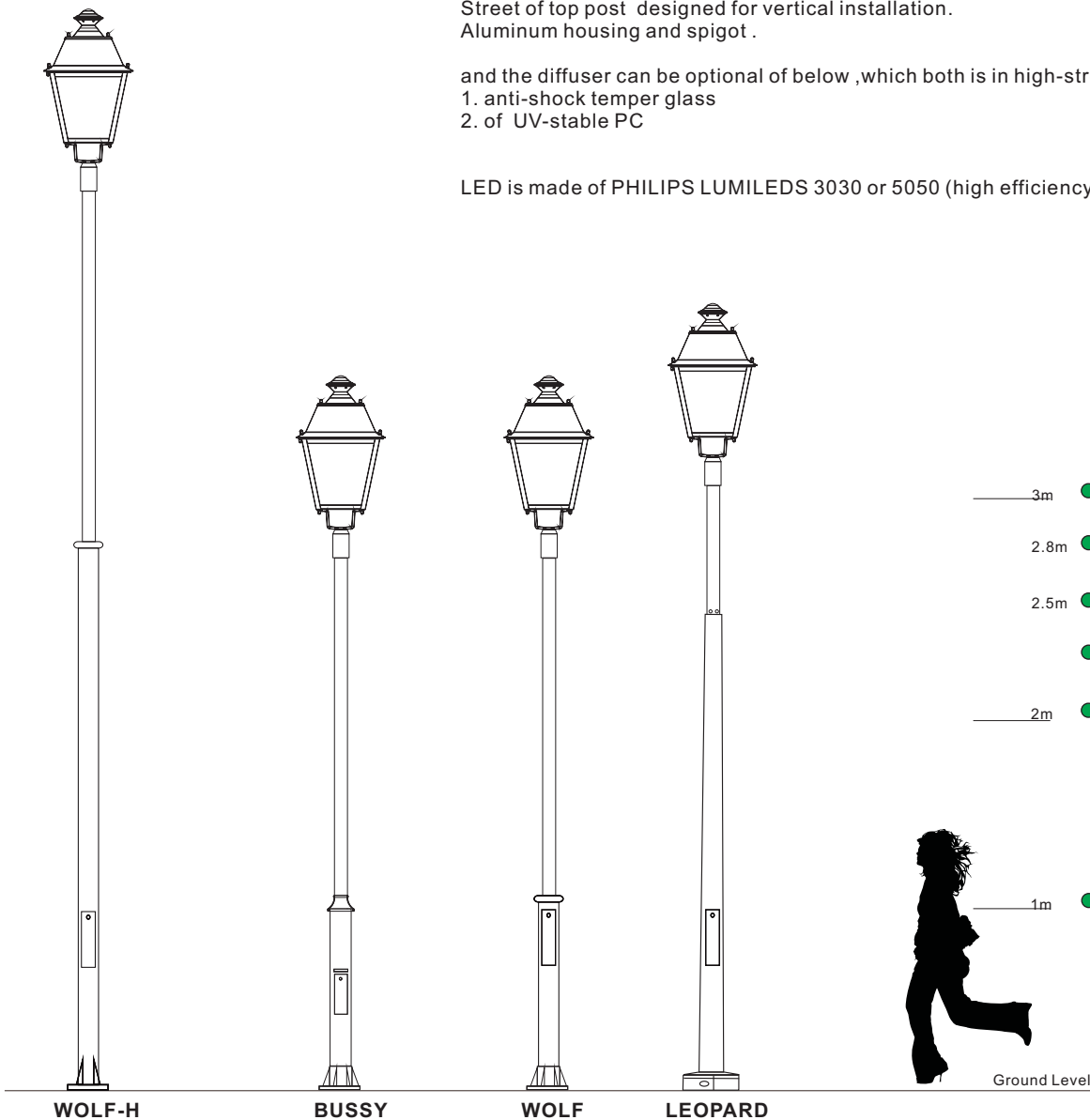

For installation of LED Street Light -Vertical Mounted Type

Model : PL30425VLA.885/Q1 , PL50425VLC.885/Q1



The photograph may not match the reference exactly. Please to read the product description to identify the finish .

LED3030 ≥ 105lm±5/W

PL30425VLC.885W30/Q1
PL30425VLC.885W40/Q1
PL30425VLC.885W50/Q1
PL30425VLC.885W60/Q1

LED5050 ≥ 130lm±5/W (high efficiency)

PL50425VLC.885W30/Q1
PL50425VLC.885W40/Q1
PL50425VLC.885W50/Q1
PL50425VLC.885W60/Q1

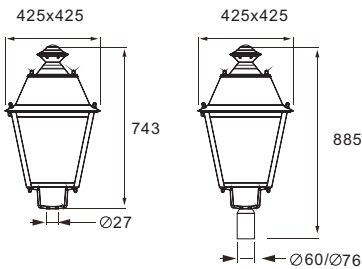

Lighting Distribution:(optional)

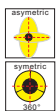

CURVING: (asymetric)

CURVING: (symetric) 120DEG Lambert light matching

Box Size/Unit : ---cm

Gross Weight (kg) : 7.8Kg/1PC

DESCRIPTION:

Street of top post designed for vertical installation. Aluminum body and anti-Shock & UV PC diffuser from LED Module ,which is in high-strength without broken .

LED is made of PHILIPS LUMILEDS 3030 or 5050 (high efficiency).

TECHNICAL CHARACTERISTICS:

Type: LED Street- Top Post Mounted
IP Protection degrees: IP68 (LED PART)
Safety Class : Class-I
Working Temperature : -25 ~ +50°C
Voltage/Frequency : 120-240V ,50/60HZ
100-277V ,50/60HZ



LED SPECIFICATIONS: (Q1,105lm±5/W /LED3030)

| | |
|---|---|
| Item No.: PL30425VLC.885W30/Q1 | Item No.: PL30425VLC.885W40/Q1 |
| LEDs: Phillips Lumileds 3030 35LEDs,30W | LEDs: Phillips Lumileds 3030 45LEDs,40W |
| Item No.: PL30425VLC.885W50/Q1 | Item No.: PL30425VLC.885W60/Q1 |
| LEDs: Phillips Lumileds 3030 49LEDs,50W | LEDs: Phillips Lumileds 3030 63LEDs,60W |

LED SPECIFICATIONS: (Q1,135lm±5/W /LED5050,high efficiency)

| | |
|---|---|
| Item No.: PL50425VLC.885W30/Q1 | Item No.: PL50425VLC.885W40/Q1 |
| LEDs: Phillips Lumileds 5050 14LEDs,30W | LEDs: Phillips Lumileds 5050 14LEDs,40W |
| Item No.: PL50425VLC.885W50/Q1 | Item No.: PL50425VLC.885W60/Q1 |
| LEDs: Phillips Lumileds 5050 18LEDs,50W | LEDs: Phillips Lumileds 5050 18LEDs,60W |



MATERIALS/FINISHES:

Structure material: Die-casting aluminium
Structure finish: Grey, White, Black, Silver

Diffuser Material: Anti-UV PC/Polycarbonate

SAMPLE FOR STICK LABELS:

Product Description **YOUR LOGO®**

60W LED STREET LIGHT

| | |
|---|---------------------------|
| Color Temp 3000K | Protection IP66 |
| Power Supply 100-240V AC, 50-60Hz | Power Rate 60W |

Product Part #: xxxxxxxx

+86 574 62805278
+86 574 62805277
sales@schtlite.com
www.schtlite.com

#49, Changxin Road, Yuyao City, Ningbo Of Zhejiang ,China

60W LED STREET LIGHT **YOUR LOGO®**

Product Part #: xxxxxxxx

| | | |
|------------|----------------------------|------------------|
| Power: 60W | Input:100-240V AC, 50-60Hz | Protection: IP66 |
|------------|----------------------------|------------------|

Stick Label of Lamp Body



No Diffuser

Frost/Clear Temper Glass

Frost/Clear PC

Stick Label of box & carton

SCHTLITE LIGHT CO., LIMITED

Office and Factory
#777, Huan cheng Rd, Yuyao City ,Ningbo Of Zhejiang ,China
Tel: +86-574-62805278 Fax: +86-574-62805277
Email : sales@schtlite.com

service at alibaba.com
we have our website at alibaba.com for all of our outdoor series of lighting with the page :
peterlamps.en.alibaba.com



For installation of LED Street Light -Vertical Mounted Type
Model : PL30425VLA.885/LQ2 , PL50425VLC.885/LQ2



The photograph may not match the reference exactly. Please to read the product description to identify the finish .

LED3030 ≥ 105lm±5/W

PL30425VLC.885W80/LQ2
 PL30425VLC.885W100/LQ2
 PL30425VLC.885W120/LQ2

LED5050 ≥ 130lm±5/W (high efficiency)

PL50425VLC.885W80/LQ2
 PL50425VLC.885W100/LQ2
 PL50425VLC.885W120/LQ2

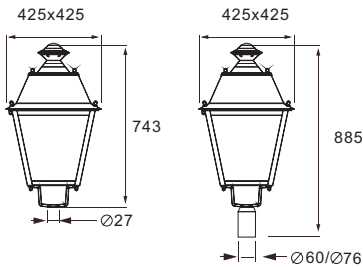

Lighting Distribution:(optional)

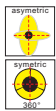

CURVING: (asymetric)

CURVING: (symetric) 120DEG Lambert light matching

Box Size/Unit : ---cm

Gross Weight (kg) : 7.8Kg/1PC

DESCRIPTION:

Street of top post designed for vertical installation. Aluminum body and anti-Shock & UV PC diffuser from LED Module ,which is in high-strength without broken .

LED is made of PHILIPS LUMILEDS 3030 or 5050 (high efficiency).

TECHNICAL CHARACTERISTICS:

Type: LED Street- Top Post Mounted
 IP Protection degrees: IP68 (LED PART)
 Safety Class : Class-I
 Working Temperature : -25 ~ +50°C
 Voltage/Frequency : 120-240V ,50/60HZ
 100-277V ,50/60HZ



LED SPECIFICATIONS: (Q1,105lm±5/W /LED3030)

Item No.: **PL30425VLC.885W80/LQ2** Item No.: **PL30425VLC.885W100/LQ2**

LEDs: Phillips Lumileds 3030 35LEDs,80W LEDs: Phillips Lumileds 3030 45LEDs,100W

Item No.: **PL30425VLC.885W120/LQ2**

LEDs: Phillips Lumileds 3030 49LEDs,120W

LED SPECIFICATIONS: (Q1,135lm±5/W /LED5050,high efficiency)

Item No.: **PL50425VLC.885W80/LQ2** Item No.: **PL50425VLC.885W100/LQ2**

LEDs: Phillips Lumileds 5050 14LEDs,80W LEDs: Phillips Lumileds 5050 14LEDs,100W

Item No.: **PL50425VLC.885W120/LQ2**

LEDs: Phillips Lumileds 5050 18LEDs,120W



MATERIALS/FINISHES:

Structure material: Die-casting aluminium
Structure finish: Grey, White, Black, Silver

Diffuser Material: Anti-UV PC/Polycarbonate

SAMPLE FOR STICK LABELS:

Product Description **YOUR LOGO®**
60W LED STREET LIGHT

| | |
|---|---------------------------|
| Color Temp 3000K | Protection IP66 |
| Power Supply 100-240V AC, 50-60Hz | Power Rate 60W |

Product Part #: xxxxxxxx

+86 574 62805278
 +86 574 62805277
 sales@schtlite.com
 www.schtlite.com

#49, Changxin Road, Yuyao City, Ningbo Of Zhejiang ,China

60W LED STREET LIGHT **YOUR LOGO®**
 Product Part #: xxxxxxxx

| | | |
|------------|----------------------------|------------------|
| Power: 60W | Input:100-240V AC, 50-60Hz | Protection: IP66 |
|------------|----------------------------|------------------|

Stick Label of Lamp Body



No Diffuser

Frost/Clear Temper Glass

Frost/Clear PC

Stick Label of box & carton

SCHTLITE LIGHT CO., LIMITED

Office and Factory
 #777, Huan cheng Rd, Yuyao City ,Ningbo Of Zhejiang ,China
 Tel:+86-574-62805278 Fax:+86-574-62805277
 Email : sales@schtlite.com

service at alibaba.com
 we have our website at alibaba.com for all of our outdoor series of lighting with the page :
peterlamps.en.alibaba.com



STREET LIGHT 2018.V1

International On-line Sales Dept.-Outdoor Light

PH: 0574-62805278

0574-62805275

FX: 0574-62805277

MB: 13958391970

(24 Hours service calling)

Email: sales@sctlite.com

peter_lamps@163.com

[Http://www.sctlite.com](http://www.sctlite.com) , sctlite.en.alibaba.com

[Http://www.peterlamps.com](http://www.peterlamps.com) , peterlamps.en.alibaba.com

Professional supplier in outdoor lighting , both in street & garden lights

SCHTLITE LIGHT CO., LIMITED

Changxin Road 39#, Yuyao City 315400, Zhejiang , China

COMPREHENSIVE VERSION BY SCHTLITE PICTURE 2018